

MAJORITY

P E M B R O K E II

INTERNET RADIO & MUSIC SYSTEM

PEM-NET-DAB -BLK-2



Instructions Guide

# Contents

<b>What's in the Box?</b> .....	1
<b>Controls And Functions</b> .....	2
<b>Support</b> .....	6
<b>Instructions Guide</b> .....	7
Basic Operation .....	8
Internet Radio.....	11
Media Centre.....	13
FM Radio.....	15
DAB/DAB+ Radio .....	16
Information Centre .....	18
Connections.....	19
Bluetooth.....	20
Spotify Connect .....	21
Configuration Settings .....	22
Settings: Additional Features .....	27
Remote Control App .....	29
<b>Troubleshooting</b> .....	31
<b>Specifications</b> .....	32
<b>Warranty</b> .....	32
<b>Safety Information</b> .....	33

**3 YEAR  
WARRANTY**

Watch video tutorials and register  
your product for a FREE 3-year warranty  
at <https://www.majority.co.uk>

## Box Contents

---

1. Majority Pembroke
2. Remote Control
3. Power Adapter
4. Instructions Guide



# Controls And Functions

## Front View

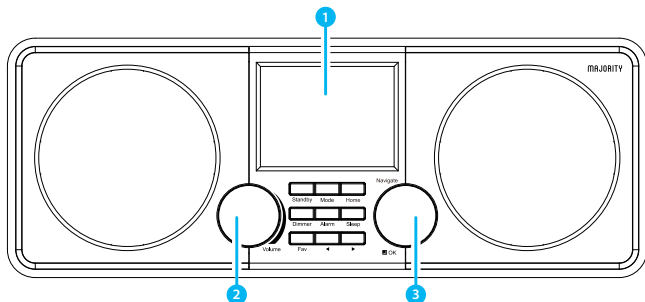

1. Display Screen
2. Volume dial
3. Navigation/OK dial

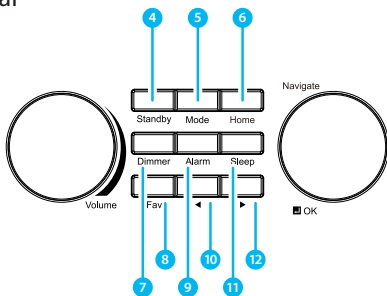

4. Standby
5. Mode
6. Home
7. Dimmer
8. Favourite
9. Alarm
10. Previous
11. Sleep
12. Next

## Back View/Connections

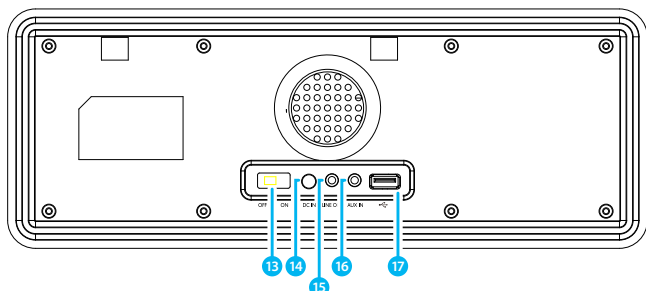

- 13. ON/OFF Switch
- 14. DC power input
- 15. Line Out

- 16. Aux In
- 17. USB Charging Port

# Controls And Functions

## Remote Control

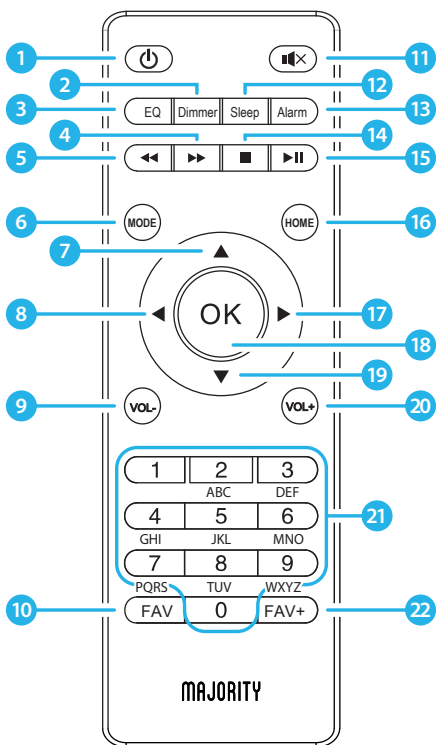

- 1. Power On/Off**  
Switch the unit between on and Standby mode
- 2. Dimmer**  
Switch between two dimmer settings
- 3. Equaliser**  
Adjust the sound to different media options for the best sound
- 4. Skip forward button**  
Skip forward through tracks in Bluetooth mode
- 5. Skip backward button**  
Skip backwards through tracks in Bluetooth Mode
- 6. MODE button**  
Scroll through available audio modes on display screen
- 7. Scroll up**
- 8. < back button/scroll left**  
Go back to previous display screen or options available. Also use to scroll left
- 9. Vol - button**
- 10. Fav Preset recall**  
When in the audio mode view favourite stations that have been set
- 11. MUTE button**  
Stop/start audio sounding
- 12. Sleep button**  
Select repeatedly until desired sleep timer set on top right of display
- 13. Alarm button**  
Select to view and create alarm options
- 14. Stop button**
- 15. Pause/Play**
- 16. HOME button**  
View main display screen
- 17. > forward button/scroll right**  
Use to go to next option/screen or scroll right.
- 18. Select button**  
Select chosen option
- 19. Scroll down**
- 20. Vol + button**
- 21. Keypad**  
Type numbers and letters
- 22. Add as a favourite/preset**  
When on the desired station, press to set as a favourite. Use the select OK button to choose preset number

### Support

---

Thank you for your purchase of the Majority Pembroke II internet radio.

Please follow the guidance of the manual to set up your new purchase and begin enjoying its features.

If you require further assistance with your new radio, please contact our support team on the Majority website:

<https://www.majority.co.uk/support/>



## Navigation Settings

---

**Standby button:** This should be used to turn your radio on and off. The Standby screen will display the time, date and any settings set such as alarms.

To turn off standby, press the Standby button to be taken to the home screen, or last function that you were using before putting into standby.

**Navigation/OK/Volume Dial:** Rotate the dial clockwise or anticlockwise to scroll through choices and press down the dial to confirm selections.

This dial will allow you to change the volume when you are on the radio station playing screen.

**Home button:** Select the Home button to view the main menu screen and browse through audio options such as Local Radio, Internet Radio, DAB Radio, FM Radio, Spotify Connect, Media Centre, Information Centre, AUX, Configuration Settings.

Use the Home button to cancel out of settings being made.

**Dimmer:** Select Dimmer to choose between the two default options. Alter dimmer's brightness in Configuration settings.

**< and > buttons:** Buttons used to alter settings. Use the 'previous' button to go back a step.

## Basic Operation

---

**Please note** that the instructions within this manual will refer to the radio button number e.g (**Ref.\*number\***) in accordance to the diagrams on pages 2-3 and (**Rem.\*number\***) to represent the remote on pages 4-5.

### Starting up your internet radio

Plug the adaptor connector into the back of the system labelled 'DC in' (**Ref. 14**) and turn the power on from the mains. Switch the button at the back of the radio to 'ON' (**Ref. 13**) to display the Welcome screen.

Ensure the antenna is extended as far as possible. This will enable you to get the best signal you can.

After the Welcome screen, you will be able to select your chosen language by scrolling with the Navigation dial (**Ref.3**). Select your language by pressing down the dial.

If this is the first time of using your radio, you will get the option to set up your Wi-Fi to stream Internet Radio with the message "Would you like to configure network now?". If you select YES, your radio will begin to scan for nearby networks to connect to.

If you select NO then you can set this up later in configuration settings.

## Manual WiFi Set-up

If you select YES, you will be able to select your chosen Wi-Fi network and enter the Wi-Fi password in the next display screen. Type letters/numbers by scrolling with the Navigation dial (**Ref.3**) until the correct digit is displayed and click '>' to go to the next digit. Once finished, press down the Navigation dial (**Ref.3**) to confirm password and start connecting.

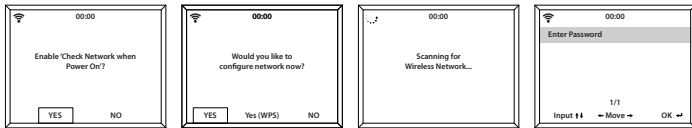

## Wireless Network (WPS PBC)

When at the “Would you like to configure network now?” stage, if you select “YES (WPS)” your radio will begin to search for Wi-Fi connections.

Whilst this has been selected you will have 120 seconds to click the WPS button on your Wi-Fi modem. This will connect your Wi-Fi to the radio without manually typing in the passcode.

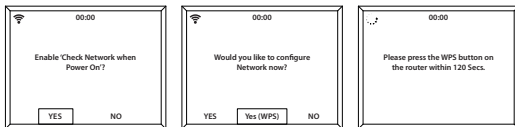

### **Wi-Fi Connection Complete!**

Once your Wi-Fi is connected by manually entering your Wi-Fi password or via WPS, you will be taken to the main menu screen and the Wi-Fi signal will appear in white at the top left. Your internet radio is now set up!

## Internet Radio

---

Go to the main menu screen by selecting the 'Home' button (**Ref.6**) and select 'Internet Radio' on the display screen by turning the Navigation dial (**Ref.3**) and pressing down the dial.

When in the 'Internet Radio' screen there will be multiple options:

**My Favourite:** Your favourite stations will be saved here for easy listening.

**Radio Station/Music:** Select this option to browse internet radio stations in the categories of: Global Top 20, Genre, Country/Location, Highlight. Find stations under relevant categories and select your chosen internet station by selecting with the Select dial.

If your station is not available via this server or found in Internet Radio > Service, please refer to page 14 'My MediaU'.

**Local Radio:** The radio is automatically set up to detect your country's top DAB stations, Top 10 stations, All Stations, plus a variety of genres into categories in alphabetical order. Select the category that you wish to listen to with the Navigation Dial (**Ref.3**) and continue browsing until you find your desired station.

**Sleep Radio:** Choose from multiple relaxation sounds.

**History:** Browse through recently listened to stations

**Service:** Search for an internet radio station or add a new station. To search a new station, select 'Search Radio Station' to go to the search tool. Turn the Navigation dial (**Ref.3**) to highlight the chosen character and click '>' (**Ref.12**) to move to the next character.

To go back to the previous character, press '<' (**Ref.10**) to highlight it. Press down the Navigation dial (**Ref.3**) when you have finished, to then begin the search for the internet station.

### Pre-setting your favourite internet stations

When you have found your desired station to save as a preset, press and **hold** the 'FAV' button on the radio (**Ref.8**) for **2-3 seconds** or press the FAV+ button on the remote (**Rem.22**) to go to the 'Add to my Favourites' screen.

Turn the Navigation dial (**Ref.3**) or use the navigation buttons on the remote to go to the preset number and select your preset number by pressing down the dial.

**Please note:** If a station has already been preset, the radio will not allow you to preset twice.

### Recalling your favourite internet stations

To view your preset favourite stations, press (do not hold) the 'Fav' button on the unit (**Ref.8**), or press the FAV button on the remote (**Rem.10**) to open the favourites recall screen with the preset stations set. Use the navigation dial (**Ref.3**) to scroll through the set stations and select by pressing down the dial.

In internet radio mode, you can also simply type in the preset number with the numbers on the remote control for quick selection (**Rem.21**).

## Media Centre

---

Select 'Media Centre' on the main display screen with the Navigation dial (**Ref.3**) or by using the navigation buttons on the remote.

### USB:

Select USB mode and plug in a USB stick (**Ref.17**) with files. Highlight the desired folder/song with the Navigation dial (**Ref.3**) and select for your chosen song to play.

### UPnP:

Universal Plug and Play allows you to connect to other devices to play your music such as personal computers (Windows media player), mobile (GooglePlay) and other devices.

Once you have selected UPnP, select the radio from your device to connect and from your phone you may need to select the radio.

**Both your device and the Pembroke II radio will need to be connected to the same WiFi network.**

Select the device with the Navigation dial you want to play music or media from on the radio display screen in UPnP settings.

If you have set up folders on your device that is being shared you can use the Navigation dial to scroll through your choices and confirm your selection by pressing down the dial.

### My Playlist:

You can create a playlist of favourite music or media from UPnP. When you are playing the media, press and **hold** the Navigation dial on the unit or the 'OK' button on the remote control (**Rem.18**) to save it into My Playlist.

Access 'My Playlist' from the Media Centre.

### Clear My Playlist:

If you have created a playlist via UPnP connection, you can select this option to clear the playlist. Select the option 'Clear my Playlist' with the Navigation dial.

The radio will then display "Confirm delete?". Select YES to delete your playlist with the Select dial.

## My Media U: Adding Stations

Stations can be manually added on to the radio via MediaU if they are not available in internet radio mode.

In configuration settings there is the option to connect a MediaU account via the website **<http://www.mediayou.net/>**

Ensure that WiFi is connected to the radio, and then obtain the wireless MAC address of the radio via Information Centre > System Information > Wireless Information. Enter this address on the MediaU website to allow the radio to sync your account.

When this is successfully configured you are then able to save and view your own MediaU station playlists.



## FM Radio

---

Select 'FM mode' on the main display screen with the Navigation dial (**Ref.3**). Once selected, the FM mode will start on 87.50MHz.

Press down the Navigation dial (**Ref.3**) and the screen will display "Auto Scan?". Select YES to begin an autoscan and receive the stations with the best signal.

To allow your radio to scan and receive FM stations with the next strongest signal, press and hold the '>' button (**Ref.12**). To scan down the bandwidth, press and hold the '<' button (**Ref.10**). To manually scroll through FM stations, simply press the '<' and '>' buttons (**Ref.10/12**).

### Pre-setting your favourite FM stations

Once the auto-scan is complete, stations will be saved in your favourites.

To save a favourite station manually on FM, press and **hold** the 'FAV' button on the radio (**Ref.8**) for **2-3 seconds** or press the FAV+ button on the remote (**Rem.22**). The number '01' will display on the screen, so use the Navigation dial (**Ref.3**) to browse through preset numbers and select the chosen preset number to save to.

**Please note: If a station has already been preset, the radio will not allow you to preset twice.**

### Recalling your favourite FM stations

View your favourite FM stations when you are on FM mode by selecting the 'Fav' button (**Ref.8**) and scroll through them with the Navigation dial (**Ref.3**). In FM radio mode, you can also simply type in the preset number with the numbers on the remote control for quick selection (**Rem.21**).

## DAB/DAB+ Radio

---

Select 'DAB/DAB+' on the main display screen by browsing with the Navigation dial (**Ref.3**) and selecting by pressing down the dial.

On first use of DAB on the Sidney, it will begin scanning for DAB stations and will show 'Scanning' on the display screen. It will display how many stations have been found as the search continues.

Once all of the available stations have been found, the screen will display the choice of available stations. Scroll through using the Navigation dial (**Ref.3**) and highlight the chosen station. Select the station by pressing down the dial.

When you have selected a station, the screen will display the station and begin to play. To choose the previous or next station, go back to the list and use the Navigation dial to scroll accordingly.

When on your chosen station, select the '>' button (**Ref.12**) to show information on the station. The screen will automatically scroll through information and display genre, MHz, song playing, KHz and Kbps.

To rescan your stations, go on the main list page for the DAB stations and select the '<' button to start a scan (**Ref.10**). This would be advisable if you are having signal issues.

## Pre-setting your favourite DAB/DAB+ stations

When you have found your desired station to save as a preset, press and **hold** the 'FAV' button on the radio (**Ref.8**) for **2-3 seconds** or press the FAV+ button on the remote (**Rem.22**) to go to the 'Add to my Favourites' screen.

Turn the Navigation dial (**Ref.3**) or use the navigation buttons on the remote to go to the preset number and select your preset number by pressing down the dial.

**Please note: If a station has already been preset, the radio will not allow you to preset twice.**

## Recalling your favourite DAB/DAB+ stations

To view your preset favourite stations, press (do not hold) the 'Fav' button on the unit (**Ref.8**), or press the FAV button on the remote (**Rem.10**) to open the favourites recall screen with the preset stations set. Use the navigation dial (**Ref.3**) to scroll through the set stations and select by pressing down the dial.

In DAB/DAB+ radio mode, you can also simply type in the preset number with the numbers on the remote control for quick selection (**Rem.21**).

### Information Centre

---

Select 'Information Centre' on the main display screen by turning the Navigation dial and pressing down the dial (**Ref.3**)

**Weather Information:** To select the weather information for a desired place, first select the continent by using the Navigation dial to scroll and select. Following this, then select the country, followed by the town/city.

Once you choose a chosen town/city, the following information will be displayed: current temperature, weather symbol image, approximate temperature range for the next 5 days.

**Financial Information:** Select from a range of stock market indexes from around the world. Scroll and select using the Navigation dial.

**System Information:** View system version and wireless connection information. If wireless information is selected, information such as WiFi's signal strength can be found.

## Connections

---

### AUX-In

Select 'AUX' on the main display screen by turning the Navigation dial and pressing the dial to select (**Ref.3**)

Plug an AUX cable into your device and connect the cable via the AUX-in port (**Ref.16**) at the back of the radio.

Begin playing audio from your device and this should play on the radio when in AUX mode.

### Line Out

At the back of the radio, the 'Line Out' (**Ref.15**) port allows for an external amplifier/stereo.

Simply connect an AUX cord from the 'Line Out' port to the amplifier/stereo.

Begin playing audio from any mode.

### Bluetooth

---

Select 'Bluetooth' on the main display screen by turning the Navigation dial and pressing down the dial (**Ref.3**), or with the remote navigation buttons.

Go to your device settings to connect your device to the radio via Bluetooth.

The internet radio's device will display as 'Majority Pembroke II'. Select this radio to connect and your radio should sound "Connected".

Select your chosen audio on your device and play.

Control the playing audio from your device, rather than with the radio's navigation buttons.

### Spotify Connect

---

Press the 'Home' button (**Ref.6**) and scroll to the Spotify Connect function.

#### **Listen out loud with Spotify Connect**

1. Connect your Majority Pembroke II to your WiFi network.
2. Open up the Spotify app on your phone, tablet or laptop using the same WiFi network.
3. Play a song and select Devices Available.
4. Select your Majority Pembroke II and start listening.

**Use your phone, tablet or computer as a remote control for Spotify.  
Go to [spotify.com/connect](https://www.spotify.com/connect) to learn how.**

The Spotify Software is subject to third party licenses found here:  
[www.spotify.com/connect/third-party-licenses](https://www.spotify.com/connect/third-party-licenses).

## Configuration Settings

---

Select 'Configuration' on the main display screen to browse through a range of display, performance and audio settings.

**Network:** Select this for Wi-Fi and network options

### Wireless Network Configuration

On the Network settings, you can set up a Wi-Fi connection by selecting Wireless Network Configuration. The radio will then start searching for available WiFi connections.

Find your WiFi connection and select it with the Navigation dial (**Ref.3**). To type letters/numbers, scroll with the dial until the correct digit is displayed and then click '>' (**Ref.12**) to go to the next digit. Press '<' if you wish to go back to previous digit (**Ref.10**) Once you are finished, press down the dial to confirm.

Once your WiFi is connected, the main menu screen will show and the WiFi signal will appear in white at the top left corner. Please note: Wi-Fi password is case sensitive.

### Wireless Network (WPS PBC)

Select this option to search for your WiFi connection. Whilst this has been selected you will have 120 seconds to click the WPS button on your WiFi modem. This will connect your WiFi to your radio without manually writing in the passcode.



## Settings: Date & Time

---

### Manually setting date and time

There is the option to manually set the time and date instead of using auto-detect to set this up.

Go to 'Configuration' settings and select 'Date&Time' by scrolling and selecting with the Navigation dial (**Ref.3**).

#### Set Date and Time

Select 'Set Date and Time' with the Navigation dial and choose 'Manual Setup'.

Change the day by highlighting the character and using the Navigation dial to scroll through to the desired unit. Once you have got the correct unit, click '>' (**Ref.12**) to go to the month. Continue this process with the year, the hour and the minutes.

Once the manual set up is complete, press down the Navigation dial (**Ref.3**) to enter.

To change the format of the date and the time, you can alter these settings under the 'Date&Time' function.

#### Set Time Format

Select the option to choose between a 12 and 24 hour clock on the time display.

#### Set Date Format

Select this option to select the order format of the date.

### Settings: Alarm Clock

---

#### Setting Alarm 1/Alarm 2

To set an alarm on your radio, go to 'Configuration' settings and scroll through to select 'Alarm' or click the 'Alarm' button (**Ref.9**)

After selecting 'Alarm' on 'Configuration' settings, or the 'Alarm' button (**Ref.9**) on the front of the radio, select Alarm 1 or Alarm 2 and highlight 'Turn On' and select this option.

Select 'Repeat' to choose the regularity of your alarm with the Navigation dial (**Ref.3**). You can choose between Everyday, Once or select individual days for the alarm to sound. Once you have made your selection, press the '<' button (**Ref.10**) to go back to the other alarm settings.

Select 'Time:' and turn the dial to highlight the alarm hour. Once you have found the desired hour, press '>' (**Ref.12**) to then change the minutes.

Once the minutes are at the correct value, press down the Navigation dial to confirm and go back to alarm settings.

Now scroll down and select 'Sound:' with the Navigation dial. You can now choose between beep, melody, internet radio, FM, DAB/DAB+ or USB.

If you are setting your alarm sound as internet radio, FM or DAB/DAB+ then you will now be taken through your preset favourite stations. Select your chosen alarm station with the dial.

## Settings: Alarm Features

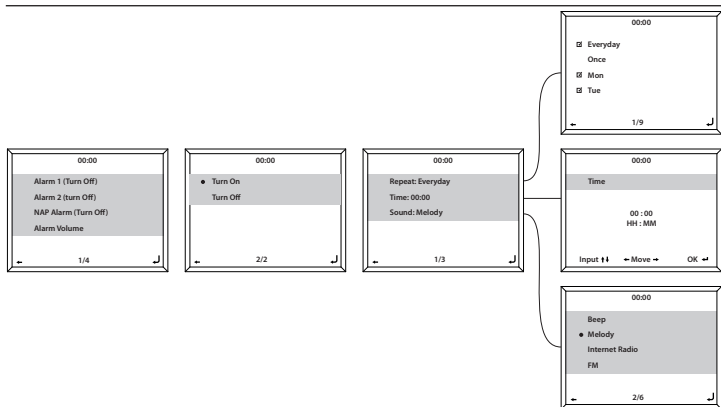

### How to cancel your alarm

To cancel your alarm, select 'Alarm' in 'Configuration' settings or with the Alarm button (**Ref.9**) and select the alarm you wish to turn off. Once the alarm is selected, you will have the option to turn off or on. Highlight the 'Turn Off' option and use the Navigation dial (**Ref.3**) to confirm.

**NOTE: Change the alarm volume by going to 'Alarm Volume' setting in the Alarm setting screen.**

### How to turn off your alarm when sounding

When your alarm is sounding, select the 'Alarm' button (**Ref.9**) or 'Standby' button (**Ref.4**) for alarm to stop. If you have set an alarm to sound everyday or more than once, the alarm icon will still remain on the main display screen.

### How to put your alarm on snooze

When your alarm is sounding, press the Navigation dial (**Ref.3**) or any other button except 'Standby' or 'Alarm' to stop the sound and put into Snooze mode. The Snooze function will make the radio sound again in 5 minutes.

Stop the Snooze alarm by pressing 'Alarm' (**Ref.9**) or 'Standby' (**Ref.4**).

### Alarm volume

Change the alarm volume by using the '<' and '>' buttons (**Ref.10/12**) to change. Once the correct sound volume has been chosen, wait a few seconds for the radio to automatically take you back to alarm setting options.

Please note: the alarm volume set here will be the alarm sounding volume. This cannot be altered when sounding.

**Please note:** The alarm volume set in this setting will be the alarm sound and it cannot be changed with the Volume/Select dial (**Ref.3**) when the alarm sounds

### Nap alarm

After selecting 'Alarm' on 'Configuration' settings, or the 'Alarm' button (**Ref.9**) on the front of the radio, select 'NAP alarm'.

Choose how many minutes you would like to have the nap alarm on with the options of: 5, 10, 20, 30, 60, 90, 120 minutes.

Once set, the Nap alarm will display on the bottom right of the standby screen as [0\*Time Set\*]. The nap alarm timer will display here how many minutes are left of the nap alarm.

## Settings: Additional Features

---

The following options are available in Configuration settings:

### Timer

In 'Configuration' settings, select the option for 'Timer' and a screen with 00:00 will display.

To go up in seconds, click the '>' button (**Ref.12**). To go down in seconds, click the '<' button (**Ref.10**). **Hold** down the '<' or '>' to move through the timer quickly.

Once you have chosen the correct timer amount, confirm it by pressing the Navigation dial (**Ref.3**) or OK on the remote.

### Dimmer

The dimmer button allows you to select two different brightness modes. You can alter the two brightness settings in 'Configuration' settings and select the option for 'Dimmer'.

Select 'Power Save' mode to change one of your brightness levels with the choice of up to 20 levels. When there is no activity of the radio for 15 seconds, this lower brightness level will set until a button is clicked and the 'Turn on' setting will activate.

Select 'Turn On' mode to be the brightness for when the radio is active and in use.

## Software Update

Will show here if a software update is available for the radio. If one is available, please select for the update to initiate.

## Reset to default

Select this option to reset your radio and revert all of the settings and presets made.

Confirm that you would like to reset the unit and its settings by selecting 'Yes'.

## Sleep Timer

To set a sleep timer, select the 'Sleep' button on the unit (**Ref.11**) or on the remote (**Rem.12**) and press repeatedly to switch between sleep times - these will display on the top right of the display screen.

There is an option between 15, 30, 60, 90, 120, 150, 180 minutes. Once this has been selected, the timer amount and a sleep image will show on the top right of the radio screen.

To turn Sleep off, simply keep selecting the 'Sleep' button until the function is removed from the display screen, or 'Turn Off' in configuration settings.

## Remote Control App

---

To begin controlling your radio via a remote control app on your smart phone or tablet, you can download the 'Air Music Control App' in your device's app store.

Firstly, ensure that your phone or tablet is connected to the same WiFi as the radio.

Alternatively, go to Configuration Settings > Device, for the following options:

**1) Rename (AirMusic)** - Select this to rename your device.

**2) AirMusic Control App** - Select this to show two QR codes - one for Apple devices, and one for Android. Scan the relevant code to download from the App store on your phone or tablet.

Once the app is downloaded, open the app and ensure that your radio is switched on and out of standby mode. The app should then automatically connect to your Majority internet radio. You can now begin adjusting settings and navigating around your radio.

### Additional Setting Options

---

**Time display** - Select Analog or Digital

**Language** - Select your chosen language within the list

**Display** - Choose the display to be Colour or Monochrome

**Power management** - Select this to configure the radio to go into standby mode automatically after a set time of inactivity or if there is no WiFi signal. Select turn off to ignore this function.

**Buffer** - Configure the buffer time of the music playback: 2/4/8/ seconds.

**Weather** - Activate/deactivate the weather forecast for the standby display. Choose your preferred temperature unit and enter your location. This will then display in the clock display on the standby screen every 10 seconds.

**Local radio setup** - Manually set up your location for Local radio rather than allowing the radio to Auto Detect.

**Playback setup** - Select the playback mode of the Media Centre: OFF, Repeat All, Repeat One or Shuffle.

**Device** - Default name for DLNA is "AirMusic". You can rename the device for DLNA setup.

**Equaliser** - Default equaliser is normal. You may change it to Flat, Jazz, Rock, Soundtracks, Classical, Pop, or News.

**Resume when power on** - Turn off the function for the radio to resume when powered on. Instead, the screen will remain in main menu.



## Troubleshooting

<b>Malfunction</b>	<b>Possible causes/measures</b>
No power / function	Check whether the power is switched on or off at the wall, and also properly connected to power outlet.
No sound	Check whether unit is set to MUTE. Check whether MODE is correctly selected. If you are connected via Bluetooth or AUX, turn up the volume on your device. Check whether cables are properly installed or not.
Function disturbance	Switch off and unplug the unit. Leave it for 2 minutes and switch it on again. Perform a factory reset and rescan for stations.
WiFi not connecting	Ensure WiFi mode is selected in settings and the correct passcode is being entered for the WiFi modem. Try connecting to the WiFi manually and via WPS. Reset your WiFi modem. Please try performing a factory reset and try reconnecting.
Bluetooth not connecting	Ensure that you are on Bluetooth mode on the radio and the Bluetooth on your device is switched on.
Radio is not allowing me to select a different station	If you have been controlling the radio via the app and then go to the radio to select a different station, this will prevent a different station from being played. Please continue controlling via the app or disconnect from the app to use the radio buttons.
My station is not available in Internet radio mode	Follow guidance on page 14 about manually adding stations to the device via mediayou.net and retrieving the radio MAC address.

## Specifications

### Specifications

---

Power Supply	DC 9V 2A (output)
Mode:	Internet Radio FM: 87.5MHz - 108 MHz DAB: 174 - 240 MHz Bluetooth Spotify Connect 3.5mm AUX-in 3.5mm Line-Out
Network	802.11b / g / n (WLAN) Encryption: WEP, WPA, WPA 2 (PSK), WPS
Dimensions	30 x 12.5 x 11.6 cm
Weight	1.58kg

### Warranty

---

All products come with a standard 12 month warranty. All items must be registered on <https://www.majority.co.uk/> for the warranty to be valid. Once on the web page, use the menu to find "Register Your Product". You will also be given the chance to extend your warranty for an additional 24 months, free of charge.

1. **Read these instructions.**
2. Keep these instructions. Instructions are also available for download at [www.majority.co.uk](http://www.majority.co.uk)
3. Heed all Warnings
4. Follow all instructions
5. Do not clean the apparatus near or with water
6. Do not block any ventilation openings. Install in accordance with the manufacturer's instructions
7. Do not install near any heat sources such as radiators, heat registers, stoves, or other apparatus (including amplifiers) that produce heat.
8. Protect the power from being walked on or pinched particularly at plugs, convenience receptacles, and the point where they exit from the apparatus.
9. Only use attachments/accessories specified by the manufacturer.
10. Unplug this apparatus during light storms or when unused for long periods of time.
11. Refer all servicing to qualified service personnel.  
Servicing is required when the apparatus has been damaged in a way, such as power-supply cord or plug is damaged, liquid has been spilled or objects have fallen into the apparatus, the apparatus has been exposed to the rain or moisture, does not operate normally or has been dropped.
12. No naked flame sources, such as lit candles, should be placed on the apparatus.
13. Dispose of used electrical products and batteries safely according to your local authority and regulations.

## ADDITIONAL WARNINGS

The apparatus shall not be exposed to dripping or splashing and no objects filled with liquid, such as vases, shall be placed on the apparatus.

Main plug is used to disconnect device and it should remain readily operable during intended use. In order to disconnect the apparatus from the main mains completely, the mains plug should be disconnected from the main socket outlet completely.

Battery shall not be exposed to excessive heat such as sunshine, fire or the like.

## RECYCLING ELECTRICAL PRODUCTS

You should now recycle your waste electrical goods and in doing so help the environment.



This symbol means an electrical product should not be disposed of with normal household waste.

Please ensure it is taken to a suitable facility for disposal when finished with.

**IMPORTANT:** Please read all instructions carefully before use and keep for future reference.



Risk of electric shock.  
Do not open



Read all instructions carefully before use and keep for future reference



When servicing, use only identical replacement parts



### CAUTION

RISK OF ELECTRIC SHOCK  
DO NOT OPEN



### ATTENTION

RISQUE D'ELECTROCUTION  
NE PAS OUVRIR



**IMPORTANT:** Please read all instructions carefully before use and keep for future reference



PEM-NET-DAB-BLK-2

# MAJORITY

[www.majority.co.uk](http://www.majority.co.uk)