



Majority **Newnham**

DAB / DAB+ / FM Radio

CB3-DAB-WHT/BLK



User Guide

Controls and Functions	1
What's in the Box?	2
Instruction Guide	3
Basic Operation.....	3
DAB Radio and Set up Preset for DAB Radio.....	4
FM Radio and Set up Preset for FM Radio	6
Station Information for DAB and FM Radio.....	8
Clock and Date Setting.....	10
Dual Alarm Setting	12
Alarm Sound and Snooze	13
Other Functions	14
Technical Specification	17
Warranty	17
Troubleshooting Guide	18
Important Safety Information	19



Watch video tutorials and register
your product for a FREE 3-year
warranty at www.majorityradios.co.uk

Controls and Functions

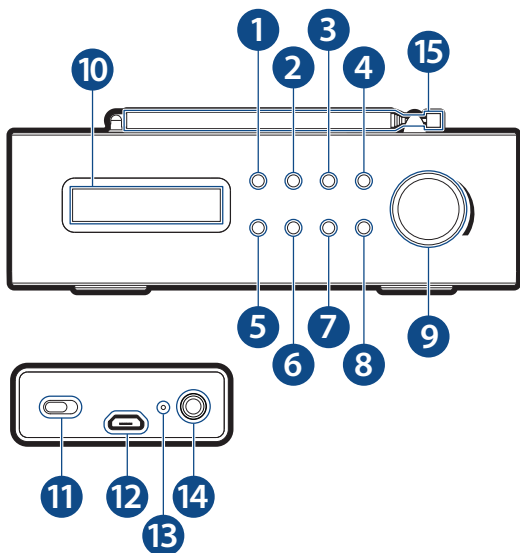

- | | | |
|------------------|------------------------------|------------------------------|
| 1. Power/Source | 8. Next | 13. Charging Light Indicator |
| 2. Alarm/Sleep | 9. Volume +/- | 14. 3.5mm Headphone Socket |
| 3. Info/Menu | 10. Display Screen | 15. Antenna |
| 4. Preset | 11. On/Off Switch | |
| 5. Select/Snooze | 12. DC 5V,1A Power Connector | |
| 6. Scan | | |
| 7. Previous | | |

What's in the Box?

- Majority Newnham DAB / DAB+ Radio Clock
- UK Standard Plug DC 5V,1A Power Supply
- User Guide



Please note all (Ref.) refer to the *Controls and Functions* mapping guide on Page 1.

Basic Operation

Plug the connector into the back of the system labelled DC 5V (Ref.12) and the power supply into the mains, if the station needs charging.

Position the Power Supply switch on the back of the system to 'ON' (Ref.11).

Ensure the antenna (Ref.15) is extended as far as possible so that you can rotate it, enabling you to get the best possible signal.

The radio will be in standby mode showing the time and date. This will automatically update after the first time you use the DAB radio.

Press the 'Power/Source' button to turn on the unit (Ref.1). It will automatically take you to DAB radio mode or the previous mode you were using.

To change the mode press the 'Power/Source' button (Ref.1) to switch between DAB Radio and FM Radio.

When DAB Radio is activated for the first time it will automatically start scanning and storing all stations that have a good signal. If the display shows "No Signal", press the scan button. It will take a few minutes for all the stations to be scanned and saved. Use the 'Prev' and 'Next' buttons (Ref.7/8) to scroll through the stations.

Standby

To place the system in standby mode, press and **hold** the 'Power/Source' button (**Ref.1**). To turn off fully, press the button on rear of the unit (**Ref.11**) and switch off at the mains. The cord must be out of reach of children.

DAB / DAB+ Radio

Press the 'Power/Source' button (**Ref.1**) to switch to DAB Radio. On first use it will automatically scan all stations and save them.

Fully extend the antenna (**Ref.15**).

To auto scan, press the 'Scan' button (**Ref.6**) and then release. This will start scanning up the frequency band and store all stations that have a good signal.

The radio will automatically save all the stations with a strong signal up to 240 MHz.

After searching has finished it will automatically play the first station stored.



IMPORTANT: *Please make sure you have extended the antenna (Ref.15) to its full length. This will then enable you to rotate it to get the best signal.*

To listen to all stations that have been stored use the 'Next' and 'Prev' buttons (**Ref.7/8**) to scroll through them. Once you have chosen, press 'Select/Snooze' button (**Ref.5**).

The radio will display station information when you press the 'Info/Menu' button (**Ref.3**). Press multiple times for different information types.

When you power up the radio again after switching off, it will automatically tune to the same station (DAB or FM) that was last selected.

How to store a preset radio station

Up to 10 preset stations can be set. To store a station that you are currently playing:

Press and **hold** 'Preset' button (**Ref.4**).

"Preset Store <1: (Empty)" will show on the display.

Press 'Prev' (**Ref.7**) or 'Next' (**Ref.8**) button to change the "<1" to the number you want to store the station as. Then press 'Select/Snooze' button (**Ref.5**) to save. The display will then show "Preset (1) stored".

How to play a preset radio station

Press the 'Preset' button (**Ref.4**).

Press 'Prev' (**Ref.7**) or 'Next' (**Ref.8**) button to scroll through your preset stations. You can store up to 10 presets.

Press 'Select/Snooze' button (**Ref.5**) to select your choice.

FM Radio

Press the 'Power/Source' button (**Ref.1**) multiple times to switch to FM. The first time you do this FM frequency "87.5 MHz" will be displayed on the screen.

Fully extend the antenna (**Ref.15**).

To auto scan, press and release the 'Scan' button (**Ref.6**). This will then start scanning up the frequency band and play the first station it finds with a good signal.

To scan down the frequency band, press and **hold** the 'Scan' button (**Ref.6**) for a few seconds.

How to tune a specific frequency manually

To listen to a specific frequency press and **hold** the 'Next' button (**Ref.8**) to search forward quickly and 'Prev' button (**Ref.7**) to search back quickly. It will stop searching when the button is released. To search slowly press the 'Next' and 'Prev' button (**Ref.7/8**) multiple times rather than holding.



IMPORTANT: *Please make sure you have extended the antenna (**Ref.15**) to its full length. This will then enable you to rotate it to get the best signal.*

How to set Mono or Stereo

Press the 'Select/Snooze' button (**Ref.5**) multiple times to change between Mono and Stereo. The receiver will automatically switch between Stereo and Mono. You can, however, override this using the above instructions.

How to store a preset radio station

Up to 10 preset stations can be set. To store a station that you are currently playing:

Press and **hold** 'Preset' button (**Ref.4**).

"Preset Store <1: (Empty)" will show on the display.

Press 'Prev' (**Ref.7**) or 'Next' (**Ref.8**) button to change the "<1" to the number you want to store the station as. Then press 'Select/Snooze' button (**Ref.5**) to save. The display will then show "Preset (1) stored".

How to play a preset radio station

Press the 'Preset' button (**Ref.4**).

Press the 'Prev' (**Ref.7**) or 'Next' (**Ref.8**) button to scroll through your preset stations. You can store up to 10 presets.

Press 'Select/Snooze' button (**Ref.5**) to select your choice.

Station Information for DAB and FM Radio

DAB / DAB+ Radio

Press the 'Info/Menu' button (**Ref.3**) repeatedly to show the different programme information.

Bit Rate: Shows the data rate at which the signal is being transmitted.

Bit Error Rate (BER): Provides details of the signal error rate.

Channel and Frequency: Displays the station's transmission channel number and frequency.

PTY (Programme Type): Shows the type and description of the programme provided by the DAB station.

Time and Date: Displays the time and date information provided by the broadcaster.

DAB Indication: Indicates DAB mode.

Dynamic Label Segment (DLS): Displays scrolling text information supplied by the broadcaster.

FM Radio

Press the 'Info/Menu' button (**Ref.3**) repeatedly to show the different programme information.

Signal Strength: Displays a signal bar with the strength of the current station.

Time and Date: Displays the time and the date.

Frequency: Displays the station's transmission frequency.

Audio Type: Displays the audio type of the station you are listening to. It will either be Stereo or Mono.

Radio Text: Displays scrolling text information supplied by the broadcaster.

Programme Type: Displays a description of the type of programme provided by the broadcaster.



Watch video tutorials and register your product for a **FREE 3-year warranty** at www.majorityradios.co.uk

Clock and Date Setting

Manually Setting the Time

Ensure the unit is in working mode. The time will automatically update after the first time of using DAB Radio, but you can still set the time manually as follows:

Press and **hold** the 'Info/Menu' button (**Ref.3**).

Use the 'Prev/Next' buttons (**Ref.7/8**) to choose your option.

Choose "Time/Date" and press the 'Select/Snooze' button (**Ref.5**).

The hour will then flash on the display screen.

Press the 'Prev' (**Ref.7**) or 'Next' (**Ref.8**) button until the required hour is displayed.

To confirm the hour press the 'Select/Snooze' button (**Ref.5**).

The minutes will then flash on the display screen. Press the 'Prev' (**Ref.7**) or 'Next' (**Ref.8**) buttons press until the required minute is displayed.

To confirm the minute press the 'Select/Snooze' button (**Ref.5**).

The time is now set.

Manually Setting the Date

The date can be changed straight after changing the time.

The year will flash on the display screen. Press the 'Prev' (**Ref.7**) or 'Next' (**Ref.8**) buttons until the required year is displayed.

To confirm the year, press the 'Select/Snooze' button (**Ref.5**).

The month will then flash on the display screen. Press the 'Prev' (**Ref.7**) or 'Next' (**Ref.8**) buttons until the required month is displayed.

To confirm the month press the 'Select/Snooze' button (**Ref.5**).

The day will then flash on the display screen. Press the 'Prev' (**Ref.7**) or 'Next' (**Ref.8**) buttons until the required date is displayed.

To confirm the date, press the 'Select/Snooze' button (**Ref.5**).



Watch video tutorials and register
your product for a FREE 3-year
warranty at www.majorityradios.co.uk

Dual Alarm Setting

Alarm 1/Alarm 2 Setting

Press (**do not hold**) the 'Alarm/Sleep' button (**Ref.5**) and "Alarm 1" will be displayed. Press twice for "Alarm 2".

Press the 'Select/Snooze' button (**Ref.5**) to use Alarm 1.

To turn the Alarm on, press the 'Next' button (**Ref.8**) so that "ON" is flashing, then press the 'Select/Snooze' button (**Ref.5**) to confirm.

The hour digits for the alarm will flash. Press the 'Prev' or 'Next' buttons (**Ref.7/8**) to change the hour and press the 'Select/Snooze' button (**Ref.5**) to confirm.

Press the 'Prev' or 'Next' buttons (**Ref.7/8**) to change the minute and press 'Select/Snooze' (**Ref.5**) to confirm.

Press the 'Prev' or 'Next' buttons (**Ref.7/8**) to change the volume and press 'Select/Snooze' (**Ref.5**) to confirm.

Press the 'Prev' or 'Next' buttons (**Ref.7/8**) to change which sound you would like: Alarm, DAB or FM Radio. Press the 'Select/Snooze' button (**Ref.5**) to confirm.

To set Alarm 2, follow Alarm 1 instructions but choose "Alarm 2 Set".

NOTE: You can press the 'Info/Menu' button (**Ref.3**) to go back to the previous step when programming the alarm.

To Turn off Alarm 1 or Alarm 2

Press the 'Alarm/Sleep' button (**Ref.2**) and "Alarm 1" will be displayed. Choose which alarm you would like to turn off using the 'Next' (**Ref.8**) button. Press the 'Select/Snooze' (**Ref.5**) button to confirm.

To turn the alarm off, press the 'Next' (**Ref.8**) button so that the word "OFF" is flashing and press the 'Select/Snooze' button (**Ref.5**) to confirm.

Alarm Sound and Snooze

Alarm Sound

The alarm will sound for a maximum of 60 minutes unless it is manually turned off.

Snooze/Switch off Alarm when Sounding

When the alarm sounds, press the 'Select/Snooze' button (**Ref.5**) to snooze for another 9 minutes. The radio will go into standby mode.

To turn the alarm off completely, press the 'Alarm/Sleep' button (**Ref. 2**).

Other Functions

Sleep Setting

This enables you to programme the radio to switch off at a selection of set times up to 120 minutes from activation.

Press and **hold** the 'Alarm/Sleep' button (**Ref.2**) for 1 second and release.

Using the 'Prev/Next' (**Ref.7/8**) buttons choose from: 5mins, 15mins, 30mins, 45min, 60mins, 90mins, 120mins or OFF.

When your choice is displayed press the 'Select/Snooze' button (**Ref.5**). The system will automatically start the timer.

To turn the sleep timer off, follow the above instructions and choose "OFF" from the choices.

Once the timer has been set, the minutes will count down on the display screen. For example, if set to turn off in 5 minutes "S5" will flash, counting down to "S0". The radio will then go into standby mode.



Watch video tutorials and register your product for a **FREE 3-year warranty** at www.majorityradios.co.uk

System Reset

Press and **hold** the 'Info/Menu' button (**Ref.3**).

Use the 'Prev/Next' buttons (**Ref.7/8**) to make your selection

Choose "Factory Reset" and press the 'Select/Snooze' button (**Ref.5**). The display screen will show "Factory Reset Yes or No?"

Use the 'Next' button (**Ref.8**) to choose between "Yes" and "No". Press the 'Select/Snooze' button (**Ref.5**) to confirm.

SW Version – Software Version Display

Press and **hold** the 'Info/Menu' button (**Ref.3**).

Use the 'Prev/Next' button (**Ref.7/8**) to make your selection.

Choose "SW Version" and press the 'Select/Snooze' button (**Ref.5**).

Headphones

You can listen to your DAB/FM Radio using headphones.

Just plug the your headphones into the 3.5mm socket at the rear of the unit (**Ref.14**).

Play Time

Your radio has a play time of around 4-6 hours. To charge it, plug your radio into the mains with the power adapter provided.

Charging

The unit will charge in standby and working mode if it is connected to the mains. To confirm that the unit is on charge, a red light will appear on the back of the system (**Ref .13**). The unit takes approximately 2.5 Hours to fully charge, after which the light will show blue.

Technical Specifications

Power Supply	In-built Battery
Mode	FM (87.5MHz – 108MHz) DAB / DAB+ (174 -240 MHz)
Output Connector	3.5mm Earphone Socket
Aerial	Integral Telescopic Aerial

Warranty

All products come with a standard 12 month warranty.

All items must be registered on www.majorityradios.co.uk for the warranty to be valid. Once on the web page use the menu to find “register your product”.

You will also be given the chance to extend your warranty for an additional 24 months free of charge.



Watch video tutorials and register your product for a FREE 3-year warranty at www.majorityradios.co.uk

Troubleshooting Guide

Observation	Potential cause/solution
No sound	The station is not tuned in. Fine tune the station. The volume is set to a low position. Increase the volume. Headphones may be connected. Disconnect the headphones.
Buttons are not working	Turn off the unit and turn on after a few seconds.
FM: Static sound DAB: Burbling/ intermittent cut-out	Signal reception is low. Adjust the aerial or move the unit to a stronger signal location. Rescan stations.
Sound is distorted	The volume is too high. Adjust the volume control.
Desired station not found	Weak signal. Use the manual tune function.
Display shows "No Service"	There is no DAB coverage in your area, or poor reception. Adjust the position of the aerial, or move the unit to a stronger signal location.
Display is blank	This may occur if the broadcaster changes the label of a service or removes a label while tuned. The radio will try to retune or perform a scan.
Time and date not setting automatically	For the time and date to set automatically you need to turn on the system and switch to DAB radio and let this scan. Then press the 'Power Mode' button and the system will go into standby and the date and clock will have been updated automatically.

IMPORTANT SAFETY INFORMATION

1. Read these instructions.
2. Keep these instructions. Instructions are also available for download at www.majorityradios.co.uk
3. Heed all Warnings.
4. Follow all instructions.
5. Do not clean the apparatus near or with water.
6. Clean only with a dry cloth.
7. Do not block any ventilation openings. Install in accordance with the manufacturer's instructions.
8. Do not install near any heat sources such as radiators, heat registers, stoves, or other apparatus (including amplifiers) that produce heat.
9. Protect the power cord from being walked on or pinched particularly at plugs, convenience receptacles, and the point where they exit from the apparatus.
10. Only use attachments/accessories specified by the manufacturer.
11. Unplug this apparatus during light storms or when unused for long periods of time.
12. Refer all servicing to qualified service personnel. Servicing is required when the apparatus has been damaged in any way, such as power-supply cord or plug is damaged, liquid has been spilled or objects have fallen into the apparatus, the apparatus has been exposed to rain or moisture, does not operate normally or has been dropped.
13. No naked flame sources, such as lit candles, should be placed on the apparatus.
14. Dispose of used electrical products and batteries safely according to your local authority and regulations.

ADDITIONAL WARNINGS

The apparatus shall not be exposed to dripping or splashing and no objects filled with liquid, such as vases, shall be placed on apparatus.

Main plug is used to disconnect device and it should remain readily operable during intended use. In order to disconnect the apparatus from the main mains completely, the mains plug should be disconnected from the main socket outlet completely.

Battery shall not be exposed to excessive heat such as sunshine, fire or the like.

RECYCLING ELECTRICAL PRODUCTS

You should now recycle your waste electrical goods and in doing so help the environment.



This symbol means an electrical product should not be disposed of with normal household waste. Please ensure it is taken to a suitable facility for disposal when finished with.

IMPORTANT: Please read all instructions carefully before use and keep for future reference



Risk of electric shock.
Do not open



Read all instructions carefully before use and keep for future reference



When servicing, use only identical replacement parts



CAUTION

RISK OF ELECTRIC SHOCK
DO NOT OPEN



ATTENTION

RISQUE D'ELECTROCUTION
NE PAS OUVRIR



IMPORTANT: Please read all instructions carefully before use and keep for future reference



MAJORITY

www.majorityradios.co.uk