

MAJORITY

P E T E R S F I E L D

POCKET DIGITAL RADIO

CB1A-DAB-BLK



EN

Instructions Guide

Box Contents	1
Controls And Functions	2
Instructions Guide	3
Navigation Controls.....	3
Basic Operation	4
DAB/DAB+ Radio Mode.....	5
DAB Station Information.....	6
Setting DAB/FM Preset Stations.....	7
FM Radio	8
Mono and Auto Audio	9
FM Station Information.....	10
Radio Settings	11
Additional Features	12
Troubleshooting	13
Specifications	14
Warranty	14
Safety Information	15

3

**YEAR
WARRANTY**

Register your product online for a **FREE 3 year**
extended warranty at: www.majority.co.uk

Box Contents

Majority Petersfield Pocket DAB

USB Charging Cable

Earphones

User Guide



Control Buttons

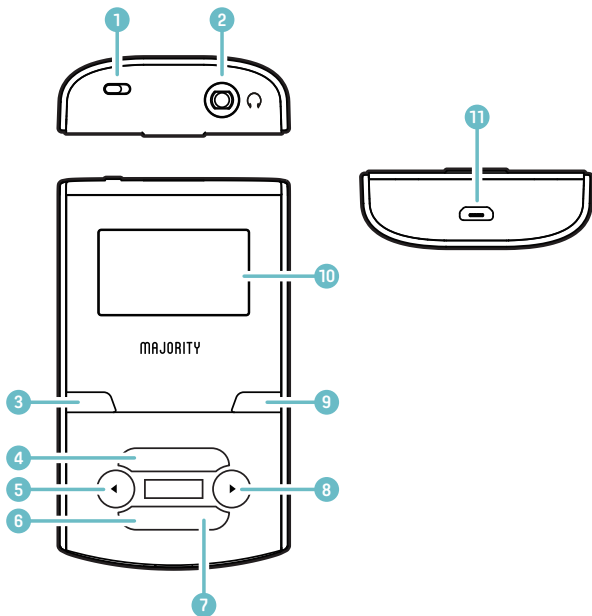

- | | | |
|-------------------|---------------|--------------------|
| 1. Power (On/Off) | 5. Previous | 9. Menu/Info |
| 2. Earphone jack | 6. Volume - | 10. Display screen |
| 3. Standby/Mode | 7. Enter/Lock | 11. USB IN jack |
| 4. Volume + | 8. Next | |

Navigation Controls

ON/OFF Button

Switch your radio ON or OFF with the switch on the top of the radio.

Standby/Mode

Press the 'Standby/Mode' button (**Ref.3**) to switch on the radio or press and hold to put it in standby mode. When in working mode, press to switch between DAB and FM mode.

Previous/Next

Use the Next and Previous buttons to navigate around the radio and browse through your selections and stations available.

In FM mode these buttons can be held down to autoscans to the next or previous available stations.

Menu/Info Button

Hold down the Menu/Info button to enter system settings.

Press repeatedly when on a DAB or FM station to view station information.

Enter/Lock button

Press the 'Enter' button when in working mode to lock and unlock the buttons.

Basic Operation

Please note all (Ref.) refer to the Controls and Functions guide on Page 2.

Ensure the device has been charged. The battery life is displayed on the screen. To charge the device, use the USB cable provided to plug it into a computer or a USB mains plug.

Ensure that the earphones included are connected to the top of the system correctly (**Ref.2**) as they also function as the antenna for your radio. Without them, no DAB/FM signal will be received.

Switch the unit on using the 'ON/OFF' button (**Ref.1**). "Welcome to Digital Radio" will show on the display, along with the clock time.

Select the radio's default language by scrolling through the available options with the '<' and '>' buttons (**Ref.5/Ref.8**) and confirm using the 'Enter' button (**Ref.7**).

The unit will automatically start scanning for stations. The device can take a few minutes to scan. If it does not automatically begin scanning and shows only "00:00" on the screen, press the 'Standby/Mode' button (**Ref.3**) to switch on the radio and the radio should begin a scan.

Once the scan is complete, the first available station in DAB/DAB+ mode will begin to play.

Standby

To change the radio back into standby, press and **hold** the 'Standby/Mode' button (**Ref.3**). To turn off fully, switch the button on top of the unit (**Ref.1**) to Off.

DAB/DAB+ Radio Mode

Please refer to **page 4** to ensure that your radio is set up correctly.

To auto scan (if the unit has not automatically done so, or has no signal) press and **hold** the 'Info/Menu' button (**Ref.9**). When the display shows "FULL SCAN", press the 'Enter' button (**Ref.7**).

The unit will start scanning up the frequency band and store all stations that have a good signal. After searching has finished the first station stored will play. Please note: signal may be adversely affected if you are not in an area with good DAB signal.

Use the '<' (**Ref.5**) and '>' (**Ref.8**) buttons to navigate through the stations stored.

The radio will display station information when you press the 'Info/Menu' button (**Ref.9**). Press repeatedly to view all information available (See **page 9**).

You can also use "MANUAL TUNE" to scroll through stations by frequency. To do this, press and **hold** the 'Info/Menu' button (**Ref.9**).

When you turn the radio on again after switching it off, it will automatically tune to the same station (DAB or FM) that was last active.

DAB Station Information

When listening to a DAB station, you can view station information. To do this, press the 'Info/Menu' button (**Ref.g**) repeatedly.

Dynamic Label Segment (DLS): Displays scrolling text information supplied by the broadcaster.

PTY (Programme Type): Shows the type and description of the programme provided by the DAB station.

Channel and Frequency: Displays the station's transmission channel number and frequency.

Bit Error Rate (BER): Provides details of the signal error rate.

Bit Rate: Shows the data rate at which the signal is being transmitted.

Time and Date: Displays the time and date information provided by the broadcaster.

Setting DAB/FM Preset Stations

How to preset a radio station

Up to 10 preset stations can be preset for easy navigation.

Press and **hold** the 'Enter' button for **2-3 seconds (Ref.7)** until the Preset settings open.

"Preset Empty x" will show on the display to indicate an empty preset number. Use the '<' (**Ref.5**) or '>' (**Ref.8**) buttons to change preset number. If a station is stored, this will display in the preset list.

Once your chosen preset number is selected, press and **hold** the 'Enter' button (**Ref.7**) to confirm. The display will then show "Preset (X) stored".

To delete a saved preset station, simply save a new station in that preset slot.

How to play a preset radio station

To recall your preset stations, press and **hold** the 'Enter' (**Ref.7**) button for **2-3 seconds** to open Preset settings.

Use the '<' (**Ref.5**) or '>' (**Ref.8**) buttons to scroll through your preset stations.

Press (do not hold) the 'Enter' button (**Ref.7**) to select the preset station you wish to play and this will begin playing.

FM Radio

Press the 'Standby/Mode' button (**Ref.3**) to switch to FM mode. The first time FM mode is selected, the FM frequency "87.5 MHz" will be displayed on the screen.

To auto scan to the next available station, press and **hold** the '>' button (**Ref.8**) and then release. To auto scan down the frequency, press and **hold** the '<' button (**Ref.5**).

After searching has finished the unit will automatically play the first station with a good signal.

How to tune a specific frequency manually

To listen to a specific frequency, you can search manually through the frequencies to fine tune.

To search slowly, press (do not hold) the '<' (**Ref.5**) and '>' (**Ref.8**) buttons.

Mono and Auto Audio

Mono and Auto

In working mode, press and **hold** the 'Info/Menu' button (**Ref.9**) to open FM settings.

Use the '>' button (**Ref.8**) to scroll through available FM settings. The options "SET TO MONO" and "SET TO AUTO" will display. To select Mono or Auto, press the 'Enter' button (**Ref.7**) to confirm.

The default audio setting for all stations is Auto mode. To improve the quality, follow the steps above to change to Mono mode.

FM Station Information

When listening to an FM station, you can access station information. To do this, press the 'Info/Menu' button (**Ref.9**) repeatedly to show the programme information.

Radio Text: Displays scrolling text information supplied by the broadcaster.

Programme Type: Displays a description of the type of programme provided by the broadcaster.

Signal Strength: Displays a signal bar with the strength of the current station.

Time and Date: Displays the time and the date.

Frequency: Displays the station's transmission frequency.

Audio Type: Displays the audio type of the station you are listening to. It will either be Auto (Stereo) or Mono.

Radio Settings

Time and Date

On first use of DAB Radio, the time and date will automatically update.

Set Language

Press and **hold** the 'Info/Menu' button (**Ref.9**) to enter radio settings. Use the '<' or '>' button (**Ref.5/Ref.8**) to select your language option. Press the 'Enter' button to confirm (**Ref.7**).

System Reset

Press and **hold** the 'Info/Menu' button (**Ref.9**) to enter radio settings. Use the '<' or '>' button (**Ref.5/Ref.8**) to scroll to the "SYSTEM RESET" option. Press the 'Enter' button to select (**Ref.7**).

To confirm the factory reset, press the 'Enter' button to confirm (**Ref.7**).

SW Version – Software Version Display

Press and **hold** the 'Info/Menu' button (**Ref.9**) to open radio settings. Use the '<' or '>' button (**Ref.5/Ref.8**) to scroll through to 'Software Version'. Press the 'Enter' button to confirm (**Ref.7**).

This will display the software version.

Additional Features

Charging the Radio

Connect the small end of the USB cable (supplied) into the charging port at the bottom of the radio (**Ref.11**). Connect the other end of the USB cable into a free USB port on your computer or another mains charger.

Your radio has an internal re-chargeable battery. The battery level is shown on the display. It is advised to fully charge the battery before removing from charge.

The battery can take up to two hours to fully charge - please refer to the charging icon on the display screen. Once charged, the radio will have 10-12 hours of battery portability.

The radio has a built-in rechargeable lithium battery with a voltage of DC5V, and a current of 500mA.

Lock/Unlock function

Press the 'Enter/Lock' button (**Ref.7**) to lock the keys when in DAB or FM working mode. When locked, a lock icon will display at the top of the screen.

Press 'Enter/Lock' again to unlock the keys.

Troubleshooting

Observation	Potential Cause/Solution
No power/function	Check that the radio is charging and use when fully charged. Ensure radio is switched on by holding down the ON/OFF button.
No sound	Check whether unit is set to MUTE. A station may not be tuned in. Perform a rescan of the DAB or FM mode and ensure that you are in an area with good signal.
Device not working	Perform a reset of the radio and try rescanning for DAB and FM stations.
Trouble receiving stations	Please ensure that your earphones are plugged in and extended as these act as the antenna. Perform a rescan for available stations.

Specifications

USB Charger Wire	5V 0.5A
Lithium battery	3.7V/1000mAh
Frequency Range	DAB: Band III 5A-13F FM: 87.5MHz to 108 MHz
Earphone output power	2 mW (32Ω)
Battery portability	9-12 hours from a full charge and dependent on DAB or FM mode.
Dimensions	9.5 x 5.5 x 1.5 cm; 99.8 g

Support

If you require further assistance with your new product, please contact our support team on the Majority website:

www.majority.co.uk/support

Warranty

All products come with a standard 12 month warranty. All items must be registered on www.majority.co.uk for the warranty to be valid. Once on the web page, use the menu to find "Register Your Product". You will also be given the chance to extend your warranty for an additional 24 months, free of charge.

1. Read these instructions.
2. Keep these instructions. Instructions are also available for download at www.majorityradios.co.uk
3. Heed all warnings
4. Follow all instructions
5. Do not clean the apparatus near or with water
6. Do not block any ventilation openings. Install in accordance with the manufacturer's instructions
7. Do not install near any heat sources such as radiators, heat registers, stoves, or other apparatus (including amplifiers) that produce heat.
8. Protect the power from being walked on or pinched particularly at plugs, convenience receptacles, and the point where they exit from the apparatus.
9. Only use attachments/accessories specified by the manufacturer.
10. Unplug this apparatus during light storms or when unused for long periods of time.
11. Refer all servicing to qualified service personnel.
Servicing is required when the apparatus has been damaged in a way, such as power-supply cord or plug is damaged, liquid has been spilled or objects have fallen into the apparatus, the apparatus has been exposed to the rain or moisture, does not operate normally or has been dropped.
12. No naked flame sources, such as lit candles, should be placed on the apparatus.
13. Dispose of used electrical products and batteries safely according to your local authority and regulations.

ADDITIONAL WARNINGS

The apparatus shall not be exposed to dripping or splashing and no objects filled with liquid, such as vases, shall be placed on the apparatus. Main plug is used to disconnect device and it should remain readily operable during intended use. In order to disconnect the apparatus from the main mains completely, the mains plug should be disconnected from the main socket outlet completely. Battery shall not be exposed to excessive heat such as sunshine, fire or the like.

RECYCLING ELECTRICAL PRODUCTS

You should now recycle your waste electrical goods and in doing so help the environment.



This symbol means an electrical product should not be disposed of with normal household waste. Please ensure it is taken to a suitable facility for disposal when finished with.

IMPORTANT: Please read all instructions carefully before use and keep for future reference.



Risk of electric shock.
Do not open



Read all instructions carefully before use and keep for future reference



When servicing, use only identical replacement parts



CAUTION

RISK OF ELECTRIC SHOCK
DO NOT OPEN



ATTENTION

RISQUE D'ELECTROCUTION
NE PAS OUVRIR



IMPORTANT: Please read all instructions carefully before use and keep for future reference

MAJORITY

www.majority.co.uk