

SCHOLARS

USER MANUAL

MAJORITY

HOME AUDIO • CAMBRIDGE

Contents	2
Box Contents	3
Controls & Functions	4
Getting Started	7
DVD Operation	8
USB Operation	9
Playing JPEG/Picture CD & MP3 Discs	10
System Set-Up	12
Troubleshooting	18
Spec & Warranty	19
Safety Information.....	20

3 | **YEAR
WARRANTY**

Register your product online for a FREE 3 year
extended warranty at: www.majority.co.uk

WHAT'S IN THE BOX

- A. Majority Scholars DVD Player
- B. Remote Control
- C. RCA AV Cable
- D. User Manual

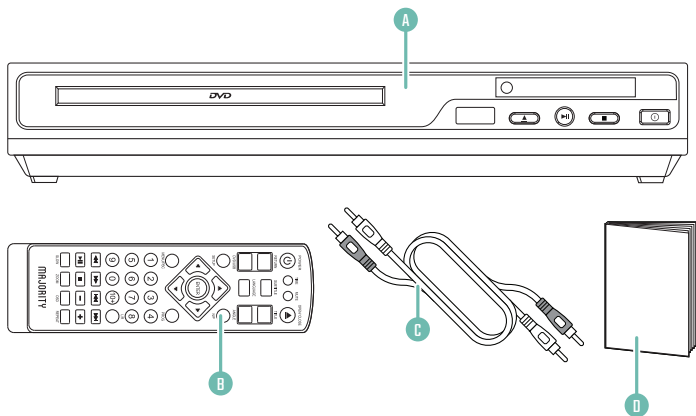

REMOTE CONTROL

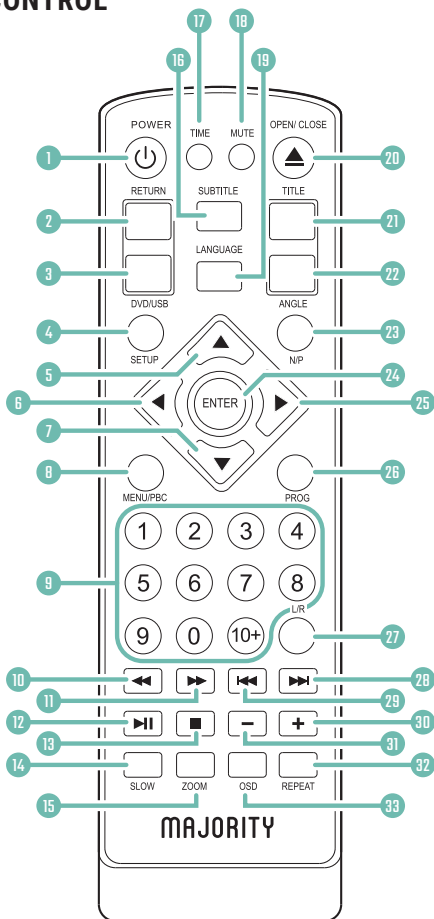

1. On/Off
2. Return: Return to VCD menu
3. Switch to DVD or USB mode
4. Setup
5. Navigate up
6. Navigate left
7. Navigate down
8. Menu/PBC: Playback control
9. 0-9/10+: Select desired track/
chapter in menu selection
10. Rewind
11. Fast-forward
12. Play/Pause
13. Stop
14. Slow
15. Zoom: Press to zoom in, press again
to zoom out. Use arrow keys to
move picture
16. Subtitles
17. Time
18. Mute
19. Language
20. Open/Close DVD Tray
21. Title
22. Angle
23. N/P: Switch between NTSC or PAL
24. Enter/Confirm
25. Navigate right
26. Programme
27. L/R: Use for VCD or CD discs. Select
left or right channel or stereo
28. Next Chapter/Track
29. Previous Chapter/Track
30. Volume Up
31. Volume Down
32. Repeat: Press repeatedly in DVD
mode to scroll through: Repeat
a title, chapter, track or go to the
beginning. In SVCD, VCD or CD
mode: Track repeat, all repeat or
repeat cancel.
33. OCD

FRONT & BACK VIEW

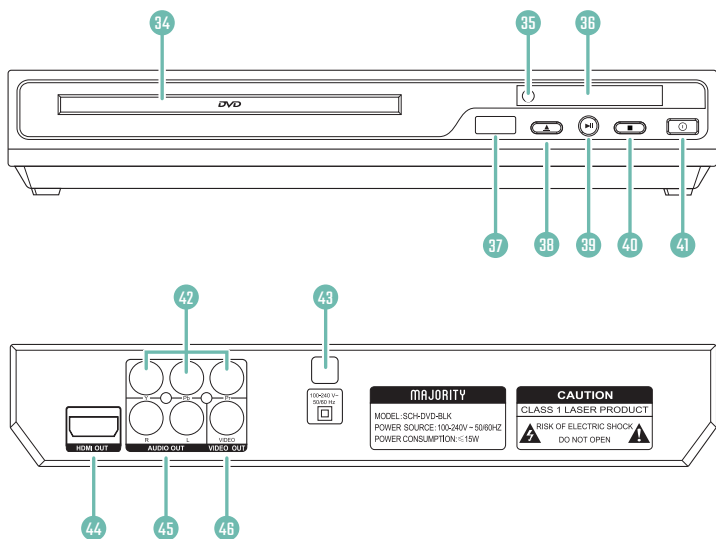

- | | | | |
|-----|---------------|-----|------------------------|
| 34. | DVD Tray | 41. | Power On/Off |
| 35. | Remote Sensor | 42. | (Y.Pb/Cb.Pr/Cr) Output |
| 36. | Display | 43. | Power Cable Outlet |
| 37. | USB Port | 44. | HDMI Output |
| 38. | Open/Close | 45. | 2 x Audio Output ports |
| 39. | Play/Pause | 46. | Video Output |
| 40. | Stop | | |

Setting Up

Connect the power plug of the DVD player to a wall outlet. The power indicator and clock on the front panel will illuminate.

Follow the guidance below for connecting your DVD player:

Cable Connection Options

1a. Connect a RCA cable between the 2 channel Audio Output port and the RCA input on your TV.

1b. Connect a HDMI cable between the HDMI Output on the back panel of the DVD player (**Ref.44**) to the HDMI input on your TV.

1c. Connect a (Y Pb/Cb Pr/Cr) cable via the (Y/Cb/Pb Cr/Pr) Output of the DVD player (**Ref.42**) to your TV (R/L/Video port and cable).

The following DVD formats can be played: DVD, DVD-R-RW, CD Video, Mpeg4.

1. Ensure that your TV is set to the correct mode for DVD playback.
2. Plug in the DVD player and press the 'Power' button to turn the unit on. You can do this on the unit (**Ref.41**) or via the remote (**Ref.1**).

When the machine is switched on, pressing the POWER button on the remote control will make it go into standby mode. Press the button again and the machine will switch on.

WARNING: If the product will not be used for an extended period of time, it is advisable to unplug it for safety.

3. Press the Open/Close button on the front panel (**Ref.38**) or on the remote control (**Ref.20**) and place a DVD disc on the disc tray. Press the Open/Close button again to close the tray.
4. The DVD will read the DVD disc and begin playing. You can control the playback and settings via the remote control.

This device has a USB port in the front interface for MP3/Movie playback.

Insert a USB device into the USB port (**Ref.37**).

Press the DVD/USB button on the remote control (**Ref.3**) to switch the source to USB. The DVD player will read and display the file list from the USB drive.

Browse through the file list by pressing the ▲/▼/◀/▶ buttons (**Ref.5, Ref.6, Ref.7, Ref.25**) on the remote control. Select a file by pressing the Enter button (**Ref.24**) of the remote control.

PLAYING JPEG/PICTURE CDS

The following formats can be played: Jpg, Jpeg, CD Photo

Press the STOP button and 12 small pictures will show on the TV screen.

Press the ▲/▼/◀/▶ buttons to select the desired picture to view. **(Ref.5), (Ref.6), (Ref.7), (Ref.25)**.

To access the instructions menu, use the ▲/▼/◀/▶ buttons to navigate and then press the ENTER button to confirm. The following options will display:

1. PROG - Select to change picture transform mode
2. STOP - Entering picture preview mode
3. PREV - Previous picture
4. NEXT - Next picture
5. PLAY - Play picture
6. UP - Mirror image in vertical
7. DOWN - Mirror image in horizontal
8. LEFT - Rotate 90 degrees anticlockwise
9. RIGHT - Rotate 90 degrees clockwise
10. ZOOM - Change zoom mode
11. FAST FORWARD - Zoom in the picture
12. FAST REWIND - Zoom out the picture
13. ▲/▼/◀/▶ - Move zoom focus for picture.

PLAYING MP3 DISCS

The following formats can be played: Mp3, WMA, CD Audio, CD-R-RW, CD

Whilst a MP3 disc is playing, a menu screen will display on the TV. Press the ▲/▼ buttons (**Ref.5, Ref.7**) to scroll through tracks or folders. Press the ENTER button to select the track or folder.

Press the PROG button in file play mode. The screen will then display the total track number and the current track playing. Use the digit buttons (**Ref.9**) to key in and select the track or use the ▲/▼/◀/▶ buttons to shift to the track and press the ENTER button (**Ref.24**) to play the track.

MENU OPERATION

Press the SET-UP button (**Ref.4**) on the remote control and the SET-UP menu will display.

The menu options are General, Audio, Dolby, Video and Preference. Follow the instructions below for each of the set up options:

- Menu 1: General
- Menu 2: Audio
- Menu 3: Dolby
- Menu 4: Video
- Menu 5: Preference

After accessing the SET-UP menu, press the ▲/▼/◀/▶ buttons (**Ref.5, Ref.6, Ref.7, Ref.25**) to access your chosen sub-menu. Press the ENTER button to confirm your selection.

To end the set-up, press the SET-UP button again.

Follow the guidance below for General, Audio, Dolby, Video and Preference settings.

MENU 1: GENERAL SET-UP

1. Press the ▲/▼/◀/▶ buttons on the remote control to open the 'General' menu (Ref.5, Ref.6, Ref.7, Ref.25).
2. Use the ▲/▼ buttons on the remote control to scroll between the sub-menus:

TV Display (Aspect Ratio)

Different values will be displayed here depending on your TV set. In most cases you will be able to select from 4:3/PS (Pan and Scan), 4:3/LB (Letterbox), and 16:9 (best for widescreen TV sets). **Please note that to change the Aspect Ratio, the disc must be stopped first.**

Angle Mark

In DVD mode, use to view DVD from different angles.

Osd Lang

Select a language for the on-screen display language (English, French, German, Italian, Spanish or Portuguese).

Captions

The default setting is Caption off. You can display closed captions (if available).

Screen saver

Select a screen saver for when the TV display goes into standby or a disc is not played for several minutes. Press any button on the remote control to wake it up.

HDCD

Select an output audio signal. You can select the digital filter to be 1 x (44.1 KHz) or 2 x (88.2 KHz).

Last Memory

If the last memory is set when the unit is on and the unit is switched off, the last position on the DVD player will be memorised.

MENU 2: AUDIO SETUP

1. Press the ▲/▼/◀/▶ buttons on the remote control to open the 'Audio' menu (**Ref.5, Ref.6, Ref.7, Ref.25**).
2. Two different submenus will appear on the menu. Press the ▲/▼ buttons on the remote control to browse between the stereo output settings:

LT/RT

The audio output is in the Left and Right channels format. Switch between left/right audio channels.

Stereo

Select to play the audio via the two front speakers of the TV.

MENU 3: DOLBY DIGITAL SET-UP

1. Press the ▲/▼/◀/▶ buttons on the remote control to open the 'Dolby' menu (Ref.5, Ref.6, Ref.7, Ref.25).
2. Two different submenus will appear. Press the ▲/▼ buttons on the remote control to browse between the sub-menus:

Dual Mono

Stereo: stereo output

L-Mono: mono-left channel

R-Mono: mono-right channel

Mix-Mono: mix mono channel

Dynamic

Select to reduce the bass and treble, to create a fine detailed sound. This mode is recommended for reduced sound to avoid disturbance for night time viewing.

MENU 4: VIDEO SET-UP

1. Press the ▲/▼/◀/▶ buttons on the remote control to open the 'Video' menu (Ref.5, Ref.6, Ref.7, Ref.25).
2. Three different submenus will appear on the menu. Press the ▲/▼ buttons on the remote control to browse between the sub-menus:

Component

Adjust the video output when connecting to video terminals.

YUV: set video output in analogue component video format when connecting to Y/U/V terminals.

Resolution (HDMI output)

You can choose the following resolution levels from the HDMI output: 480I/576I/720P 50/720P60/1080I50/1080I60/1080P (50Hz)/1080P (60Hz)

This DVD player can produce up to 1080P video resolution output. The maximum resolution will depend on the video source and the TV set.

Quality

You can set the sharpness, brightness and contrast according to your preference.

MENU 5: PREFERENCE SET-UP

To access the Preference section, the player must be in one of the following states: 1) with the disc tray open; or 2) with the disc tray closed but with no disc inside. Press the ▲/▼/◀/▶ buttons on the remote control to open the 'Preference' menu (Ref.5, Ref.6, Ref.7, Ref.25).

Seven different submenus will appear. Press the ▲/▼ buttons on the remote control to select menu options.

TV Type

This unit is suitable for a wide variety of TVs. You can select PAL or NTSC if necessary. PAL must be selected for use in Europe.

Audio

If supported by the disc content, the audio settings can be changed.

Subtitle

If supported by the disc content, the subtitle settings can be changed. An alternative way to access this menu is by pressing the SUBTITLE button.

Disc Menu

If supported by the disc content, the Disc Menu settings can be changed.

Parental

Select to control parental control settings. Any disc with a parental level higher than the set level will not be played.

Password Set-up

The initial factory password is 0000. You can change the password here.

Default Set-up

Select to revert to original factory set up on this unit.

Symptoms	Solutions
No power/function	Check that the power is switched on at the wall. Check that the power adaptor is properly connected to power outlet.
No video	Make sure that the video cables are connected correctly. Reset the settings of the DVD player. Check that the input setting on the TV is correct.
No audio	Make sure that the audio cables are connected correctly. Make sure that the coaxial connected stereo is powered on. Reset the settings of the DVD player.
Distorted video	Clean DVD disc of dust/dirt The playback is on rewind/fast forward mode.
Unable to play	Place a DVD disc in the disc tray. Place the disc in on the correct side up. Clean DVD disc of dust/dirt. Close the setup of the DVD player. Check that the file is compatible with the unit.
Remote Control does not work	Aim the Remote Control towards the front panel of the DVD player. Use the Remote Control closer to the DVD player. Check the battery level of the batteries.

SUPPORT

If you require further assistance with your new DVD player, please contact our support team on the Majority website: www.majority.co.uk/support

SPECIFICATIONS

Power Supply	AC 100-240V 0.5A
Frequency Response	~ 50/60Hz
Power Consumption	<15W
Compatible Connections	HDMI A/V RCA Output USB Input (Y Pb/Cb Pr/Cr) R/L/Video
Compatible Formats	DVD: DVD, DVD-R-RW, CD Video, Mpeg4 AUDIO: Mp3, WMA, CD Audio, CD-R-RW, CD PHOTO: Jpg, Jpeg, CD Photo
Dimension (WxHxD)	22.5 x 19 x 4.5 cm 742g

WARRANTY

All products come with a standard 12 month warranty. All items must be registered on www.majority.co.uk for the warranty to be valid. Once on the web page, use the menu to find "register your product". You will also be given the chance to extend your warranty for an additional 24 months, free of charge.

1. Read these instructions.
2. Keep these instructions. Instructions are also available for download at www.majority.co.uk
3. Heed all Warnings
4. Follow all instructions
5. Do not clean the apparatus near or with water
6. Do not block any ventilation openings. Install in accordance with the manufacturer's instructions
7. Do not install near any heat sources such as radiators, heat registers, stoves, or other apparatus (including amplifiers) that produce heat.
8. Protect the power from being walked on or pinched particularly at plugs, convenience receptacles, and the point where they exit from the apparatus.
9. Only use attachments/accessories specified by the manufacturer.
10. Unplug this apparatus during light storms or when unused for long periods of time.
11. Refer all servicing to qualified service personnel. Servicing is required when the apparatus has been damaged in a way, such as power-supply cord or plug is damaged, liquid has been spilled or objects have fallen into the apparatus, the apparatus has been exposed to the rain or moisture, does not operate normally or has been dropped.
12. No naked flame sources, such as lit candles, should be placed on the apparatus.
13. Dispose of used electrical products and batteries safely according to your local authority and regulations.

ADDITIONAL WARNINGS

The apparatus shall not be exposed to dripping or splashing and no objects filled with liquid, such as vases, shall be placed on the apparatus.

Main plug is used to disconnect device and it should remain readily operable during intended use. In order to disconnect the apparatus from the main mains completely, the mains plug should be disconnected from the main socket outlet completely.

Battery shall not be exposed to excessive heat such as sunshine, fire or the like.

RECYCLING ELECTRICAL PRODUCTS



You should now recycle your waste electrical goods and in doing so help the environment.

This symbol means an electrical product should not be disposed of with normal household waste.

Please ensure it is taken to a suitable facility for disposal when finished with.

IMPORTANT: Please read all instructions carefully before use and keep for future reference.



Risk of electric shock.

Do not open



Read all instructions carefully before use

and keep for future reference



When servicing, use only identical

replacement parts



CAUTION

RISK OF ELECTRIC SHOCK
DO NOT OPEN



ATTENTION

RISQUE D'ELECTROCUTION
NE PAS OUVRIR



IMPORTANT: Please read all instructions carefully before use and keep for future reference



MAJORITY

WWW.MAJORITY.CO.UK