

MAJORITY

TRU 1

COMPACT WIRELESS EARBUDS

Tru-1



Instructions Guide

What's In The Box?	1
Earphone Fitting	2
Pairing and charging	4
Control.....	5
Reset.....	6
Descriptions of LED indications	7
Specifications	8
Support	8
Warranty.....	8
Safety Information	9

3

**YEAR
WARRANTY**

Register your product online for a FREE 3 year
extended warranty at: www.majority.co.uk

Box Contents

Inside the Box:

1.Majority Tru 1 Wireless Earbud	×2PCS
2.On-the-go Charging Case	×1PCS
3.Type C Charging Cable	×1PCS
4.Eartips(Size S/M/L)	×3Pairs
5.User Manual	×1PCS
6.Welcome Guide	×1PCS
7.CE Declaration	×1PCS

Specification:

Bluetooth Version:BT5.2+EDR

Earbud Charging time:1.5 hours

Charging case Charging time:2.5 hours

Earbud Battery:3.7V/30mAh

Charging Case Battery:3.7V/300mAh

Safety Precautions:

- 1.Please keep the device away from extreme heat, humidity or corrosive environment.
- 2.Please don't over-charge the earbuds or charging case for a longer than required amount of time, as they may decrease the lifetime of battery performance.
- 3.Use a dry cloth to wipe the earbud charging pins after using the earbuds.



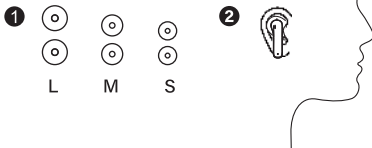

Wearing: Choose the silicone eartips that are most suitable for your ears.

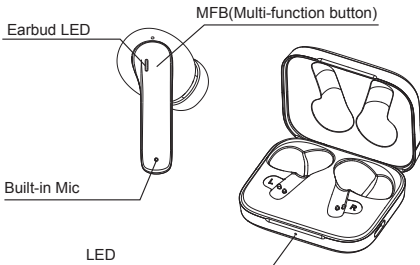

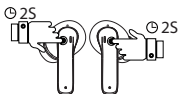

OFF

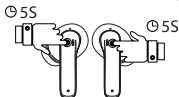
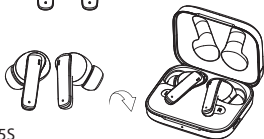

ON/OFF: When the charging case battery level is sufficient, open the charging case.

The earbuds will automatically turn on. Put them into the case and close the cover- the earbuds will automatically turn off.

Note: You can also turn on or turn off the earbuds manually- Press and hold the MFB on L/R for 2 seconds to turn on the earbuds. Press and hold the MFB on L/R for 5 seconds to turn off the earbuds when they are not connected with devices..



Pairing

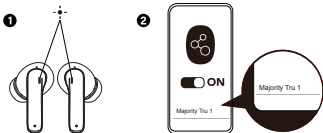

Pairing: When the charging case battery level is sufficient, open the charging case- the earbuds will automatically turn on then enter Bluetooth pairing mode.

At this time, the indicator of the main earbud will flash red and white alternately and the indicator of the secondary earbud will flash white every 3 seconds.

Please turn on the Bluetooth function on your device, search "Majority Tru 1" and click to connect.



Charging

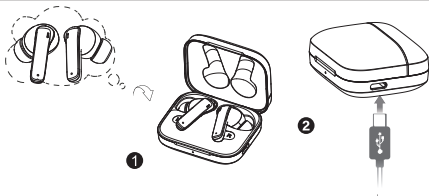

Charging: Before using, please make sure the charging case and the earbuds are fully charged.



Control

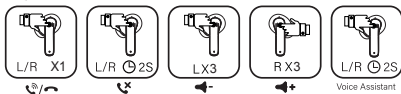

Play/Pause: One-tap the MFB on L/R.

Previous Song: Double-tap on the MFB on L.

Note: In mono mode, double-tap on the MFB on L will trigger next song function.

Next Song: Double-tap on the MFB on R.

Volume Down: Triple-Tap the MFB on L to decrease the volume .

Note: In mono mode, volume adjustment is unavailable.

Volume up: Triple-Tap the MFB on R to increase the volume .

Note: In mono mode, volume adjustment is unavailable.

Answer/End a call: One-tap the MFB on L/R.

Reject a call: Press and hold the MFB on L/R for 2 seconds when calling.

Activate Voice Assistant: Press and hold the MFB on L/R for 2 seconds.

Note: In mono mode, holding the MFB on L/R for 2 seconds will turn on the voice assistant.



Reset

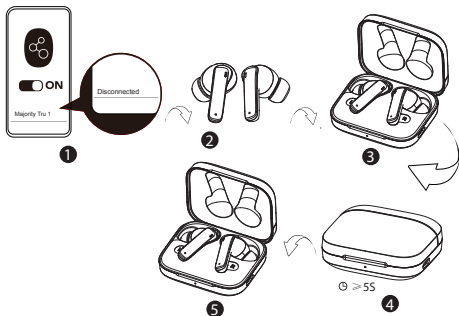

Reset:

- 1) Delete the pairing name "Majority Tru 1" on your mobile phone and turn off the Bluetooth function.
- 2) Put the earbuds back into charging case and close the cover, Leave it for 5 seconds.
- 3) Open the charging case to turn on "Majority Tru 1", the reset is successful.



Descriptions of LED indicators

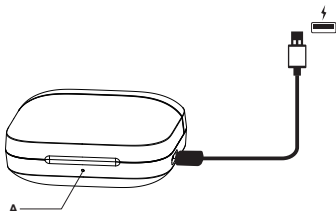

LED Indicator

Charging the case : Red LED flashes slowly to indicate the case is receiving charge, and turns off when fully charged.

Charging the earbuds: Green LED on earbud remains on to indicate receiving charge, and turns off when earbuds are full charged.

Charging case when low battery: Blinking green light flashes.

Troubleshooting

1. No Power/Function	Check both earbuds and charging case are fully charged.
2. No Sound	Make sure it is connected with your device correctly. If yes, triple click the right earbuds to increase the volume.
3. Earbuds cannot be charged	Clean the charging contacts of earbuds and charging case.
4. One of the earbuds cannot be connected	Put both earbuds back in charging case and close the charging case, open the case after 10 seconds.

Specifications

Power Supply	DC5V (USB-C)
Driver	32ohm/8mw
Driver size	Φ13mm
Frequency response	180-20KHZ
Bluetooth	V5.2
Earbuds battery	3.7V 30mAh(Each earbud)
Charging case battery	3.7V 300mAh
Dimension (WxHxD)	58x 48 x 26 mm
Net Weight	40g

Support

If you require further assistance with your new Majority Tru 1, please contact our support team on the Majority website:

www.majority.co.uk/support

Warranty

All products come with a standard 12 month warranty. All items must be registered on www.majority.co.uk for the warranty to be valid. Once on the web page, use the menu to find "Register Your Product". You will also be given the chance to extend your warranty for an additional 24 months, free of charge.

1. Read these instructions.
2. Keep these instructions. Instructions are also available for download at www.majority.co.uk.
3. Heed all warnings.
4. Follow all instructions.
5. Do not clean the apparatus near or with water.
6. Do not block any ventilation openings. Install in accordance with the manufacturer instructions.
7. Do not install near any heat sources such as radiators, heat registers, stoves, or other apparatus including amplifiers that produce heat.
8. Protect the power from being walked on or pinched particularly at plugs, convenience receptacles, and the point where they exit from the apparatus .
9. Only use attachments/accessories specified by the manufacturer .
10. Unplug this apparatus during light storms or when unused for long periods of time .
11. Refer all servicing to qualified service personnel.
Servicing is required when the apparatus has been damaged in a way, such as power-supply cord or plug is damaged, liquid has been spilled or objects have fallen into the apparatus, the apparatus has been exposed to the rain or moisture, does not operate normally or has been dropped .
12. No naked flame sources, such as lit candles, should be placed on the apparatus .
13. Dispose of used electrical products and batteries safely according to your local authority and regulations.

ADDITIONAL WARNINGS

The apparatus shall not be exposed to dripping or splashing and no objects filled with liquid, such as vases, shall be placed on the apparatus.
Main plug is used to disconnect device and it should remain readily operable during intended use. In order to disconnect the apparatus from the main completely, the mains plug should be disconnected from the main socket outlet completely.
Battery shall not be exposed to excessive heat such as sunshine, fire or the like.



RECYCLING ELECTRICAL PRODUCTS

You should now recycle your waste electrical goods and in doing so help the environment .

— This symbol means an electrical product should not be disposed of with normal household waste . Please ensure it is taken to a suitable facility for disposal when finished with.



IMPORTANT: Please read all instructions carefully before use and keep for future reference .



Risk of electric shock .
Do not open



Read all instructions carefully before use and keep for future reference

When servicing, use only identical replacement parts



CAUTION

RISK OF ELECTRIC SHOCK
DO NOT OPEN



ATTENTION

RISQUE D'ELECTROCUTION
NE PAS OUVRIR



IMPORTANT: Please read all instructions carefully before use and keep for future reference

MAJORITY

www.majority.co.uk