

MAJORITY

EDDINGTON

PORTABLE DIGITAL RADIO

EDD-DAB-BLK



Instructions Guide

Contents

| | |
|---|----|
| Controls And Functions | 1 |
| What's In The Box? | 3 |
| Support | 4 |
| Instructions Guide | 5 |
| Basic Operation | 5 |
| DAB/DAB+ Radio..... | 6 |
| DAB/DAB+ Preset Stations..... | 7 |
| DAB/DAB+ Radio Settings | 9 |
| FM Radio..... | 10 |
| FM Radio Presets | 12 |
| Bluetooth..... | 14 |
| System Settings: Sleep Timer | 15 |
| System Settings: Dual Alarm | 16 |
| System Settings: Additional Functions | 18 |
| Internal Rechargeable Battery | 20 |
| Troubleshooting | 21 |
| Specifications | 22 |
| Warranty | 22 |
| Safety Information | 23 |

**3 YEAR
WARRANTY**

Watch video tutorials and register
your product for a FREE 3-year warranty
at <https://www.majority.co.uk>

Front View

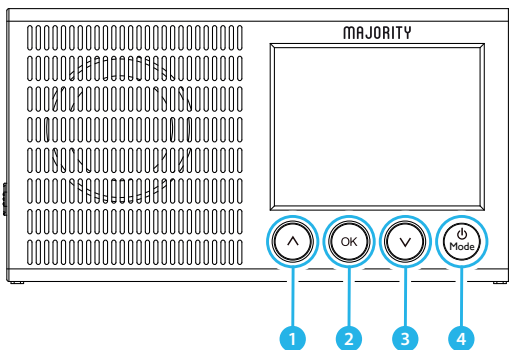

1. Up button
2. OK button

3. Down button
4. Standby/Mode

Top View

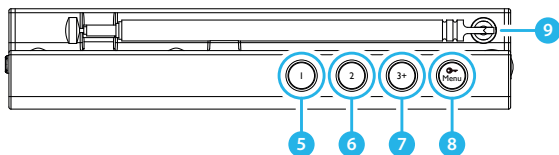

5. Preset 1
6. Preset 2
7. Preset 3+

8. Lock/Menu
9. Antenna

Controls And Functions

Side Views

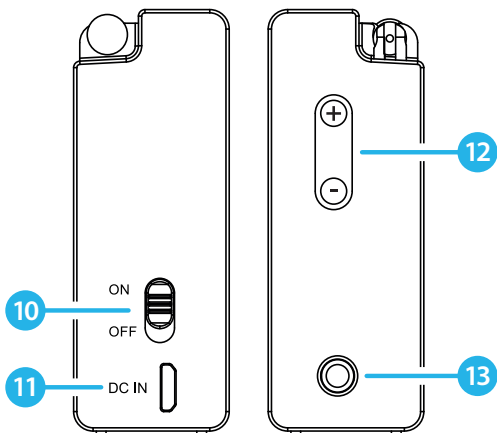

- 10. ON/OFF switch
- 11. DC in port
- 12. Volume +/-
- 13. Headphone Jack

Box Contents

1. Majority Eddington Radio
2. USB Power Supply
3. User Guide



Support

Thank you for your purchase of the Majority Eddington.

Please follow the guidance of the manual to set up your radio and enjoy its fantastic variety of stations and features.

If you require further assistance with your new radio, please contact our support team on the Majority website:

<https://www.majority.co.uk/support/>

Basic Operation

Please note all (Ref.) refer to the Page 1-2 Controls and Functions guide.

Plug the USB cable into a power source and connect into the side of the radio, labelled “DC IN” (**Ref.11**) to power and charge the radio. Alternatively, charge the radio for approximately 4 hours to charge the internal battery. This will allow for approximately 11 hours of charge and portability.

Ensure the antenna (**Ref.9**) is extended as far as possible. This will allow the radio to receive the best possible signal before DAB or FM mode is selected.

At the side of the radio, switch the ‘ON/OFF’ toggle to “ON” (**Ref.10**) and “MAJORITY” will display on the screen as the radio loads.

On first set up, the radio will begin to scan for available DAB/DAB+ stations and will display “Scanning...” as the radio scans. Once the scan is complete, the first available station will begin to play. If a scan for digital stations does not occur, refer to page 6.

Press the ‘Standby/Mode’ button (**Ref.4**) repeatedly to switch between DAB, FM and Bluetooth modes.

Standby and Lock Feature

To switch your radio to Standby mode, press and **hold** the ‘Standby/Mode’ button (**Ref.4**). To turn on the radio, simply press the ‘Standby/Mode’ button.

You can lock the buttons of the radio for convenience on the go by pressing and **holding** down the ‘Lock/Menu’ button (**Ref.8**) for 2 seconds. “Locked” will then display. To unlock buttons, repeat the same action and “Unlocked” will then display.

DAB/DAB+ Radio

Press the 'Standby/Mode' button (**Ref.4**) to switch to DAB/DAB+ Radio.

Fully extend the antenna (**Ref.9**) to receive the best possible signal.

On first use the radio will have already automatically scanned for all available stations and saved them. If you would like to rescan for available stations, press the 'Menu' button (**Ref.8**) to open settings and scroll through options with the '^/v' buttons (**Ref.1/3**). Select "FULL SCAN" with the 'OK' button (**Ref.4**) to initiate a full scan for available stations. After searching has finished it will automatically play the first station stored.

To browse through all stations that have been stored, use the '^' or 'v' buttons (**Ref.1/3**) to scroll through the available stations. When on the chosen station you wish to play, press the 'OK' button (**Ref.2**) to begin listening to that station.

When you turn the radio on again after it switching off, it will automatically tune to the same mode (DAB, FM or Bluetooth) that was last selected.

DAB/DAB+ Preset Stations

How to store a preset DAB station

To be able to quickly access your favourite DAB stations, you can preset the stations. Up to 10 different preset stations can be set for you to browse between.

To store a station as a preset, it is best to be listening to the station at the time.

From the unit, you can easily set preset numbers 1-2 by pressing and **holding** down the Preset '1' or Preset '2' buttons (**Ref.5/6**). Please ensure that the button is held for **2-3 seconds** rather than pressed. The screen will then display "Preset x Saved".

To set preset number 3+, press and **hold** down the Preset '3+' button (**Ref.7**) to open the 'Save to Preset' screen. Please ensure that the button is held for 2-3 seconds rather than pressed. Use the '^/v' buttons (**Ref.1/3**) to scroll through preset numbers and select the preset number by pressing down the OK button (**Ref.2**).

Please note: To remove a preset option that has been made, simply preset another radio station over the preset number.

How to play a preset radio station

You can easily recall presets 1 and 2 by pressing the Preset '1' or Preset '2' buttons (**Ref.5/6**). Please ensure that the button is being pressed and released, rather than held. The radio will then begin playing the selected station.

To recall preset number 3+, press (do not hold) the Preset '3+' button (**Ref.7**) to open the 'Preset Recall' screen. Use the '^/v' buttons to scroll through the preset numbers and select the preset station to play by pressing the 'OK' button (**Ref.2**).

Station Information for DAB Radio

When you are listening to a DAB/DAB+ radio station with good signal, you can press the 'OK' button (**Ref.2**) repeatedly to show the different programme information.

Dynamic Label Segment (DLS): Displays scrolling text information supplied by the broadcaster.

PTY (Programme Type): Shows the type and description of the program provided by the DAB station.

Channel and Frequency: Displays the station's transmission channel number and frequency.

Signal Strength: Displays a signal bar with the strength of the current station.

Bit Error Rate: Provides details of the signal error rate.

Time and Date: Displays the time and date information provided by the broadcaster.

DAB/DAB+ Radio Settings

On DAB mode, open DAB radio settings by pressing the 'Menu' button (**Ref.8**) (do not hold down the button). The following setting options will then display:

Station List: Select this option to view the available stations to begin playing on the unit. Select a station to play by pressing down the 'OK' button (**Ref.2**)

Full Scan: Select to begin a full scan for available digital radio stations. This would be advisable to receive more stations or resolve any signal issues.

Manual Tune: Select this option to scroll through available stations by their DAB channel and frequency (MHz). Select a station to play by pressing down the 'OK' button.

Prune Invalid: Select this option to remove invalid stations or stations with poor signal. When "Proceed to prune the invalid stations?" shows, select "Yes" to set prune option.

DRC (Dynamic Range Compression): Select this option to reduce the volume of louder sounds and boost the volume of quieter sounds. Select High, Low or Off.

System Settings: Press to open and edit system setting options such as a Sleep Timer, Alarm, Time/Date, Backlight, Language, Factory Reset, Software Update and Software Version. These settings will be explained on pages 15-19 of the manual.

FM Radio

Press the 'Standby/Mode' button (**Ref.4**) multiple times to switch between DAB, FM and Bluetooth. The first time you do this, the FM frequency "87.5 MHz" will be displayed on the screen.

Fully extend the antenna (**Ref.9**).

On first use of FM radio, initiate a manual scan up the bandwidth for available stations by pressing and **holding** the 'v' button (**Ref.3**) for 3 seconds. The FM will now increase quickly as it scans. Once the bandwidth has been scanned, the first stored and available station up the bandwidth will begin to play.

To scan quickly up the bandwidth between saved stations, press and **hold** the 'v' button (**Ref.3**) for 3 seconds and then release. The next available station will then begin to play.

To scan down the frequency band between saved stations, press and **hold** the '^' button (**Ref.1**) for 3 seconds and then release. The previous available station will then begin to play.

To tune a specific frequency manually

To tune to a specific frequency, press (do not hold) the (^) or (v) buttons (**Ref.1/3**) to search forward or back slowly through the FM bandwidth.

FM Scan Setting

Choose between scanning strong and weak signals or only the strong stations.

Press the 'Menu' button (**Ref.8**). Scroll to "Scan Setting" by using the '^' or 'v' buttons (**Ref.1/3**) to choose your option.

Select "Scan Setting" by pressing the 'OK' button (**Ref.2**).

Use the '^' or 'v' buttons (**Ref.1/3**) to choose between "Strong Stations Only" or "All Stations". Press down the 'OK' button (**Ref.2**) to confirm your choice.

Mono and Stereo

Choose between Mono and Stereo settings for FM mode.

Press the 'Menu' button (**Ref.8**). Scroll to "Forced Mono" by using the '^' or 'v' buttons (**Ref.1/3**) to choose your option.

Select "Forced Mono" by pressing the 'OK' button (**Ref.2**).

Use the '^' or 'v' buttons (**Ref.1/3**) to choose between "Yes" (Forced Mono) or "No" (Stereo). Press down the 'OK' button (**Ref.2**) to confirm your choice.

FM Radio Presets

How to store a preset FM station

To be able to quickly access your favourite FM stations, you can preset the stations. Up to 10 different preset stations can be set for you to browse between.

To store a station as a preset, it is best to be listening to the station at the time.

From the unit, you can easily set preset numbers 1-2 by pressing and **holding** down the Preset '1' or Preset '2' buttons (**Ref.5/6**). Please ensure that the button is held for **2-3 seconds** rather than pressed. The screen will then display "Preset x Saved".

To set preset number 3-10, press and **hold** down the Preset '3+' button (**Ref.7**) to open the 'Save to Preset' screen. Please ensure that the button is held for 2-3 seconds rather than pressed. Use the '^/v' buttons (**Ref.1/3**) to scroll through preset numbers and select the preset number by pressing down the OK button (**Ref.2**).

Please note: To remove a preset option that has been made, simply preset another radio station over the preset number.

How to play a preset radio station

You can easily recall presets 1 and 2 by pressing the Preset '1' or Preset '2' buttons (**Ref.5/6**). Please ensure that the button is being pressed and released, rather than held. The radio will then begin playing the selected station.

To recall preset number 3-10, press (do not hold) the Preset '3+' button (**Ref.7**) to open the 'Preset Recall' screen. Use the '^/v' buttons to scroll through the preset numbers and select the preset station to play by pressing the 'OK' button (**Ref.2**).

Station Information for FM Radio

When you are listening to a FM station with good signal, you can press the 'OK' button (**Ref.2**) repeatedly to show the different programme information.

Radio Text: Displays scrolling text information supplied by the broadcaster.

Frequency: Displays the station's transmission frequency.

Programme Type: Displays a description of the type of programme provided by the broadcaster.

Audio Type: Displays the audio type of the station you are listening to. It will either be stereo or mono.

Time and Date: Displays the time and the date.

Bluetooth

To choose Bluetooth mode, press the 'Standby/Mode' button (**Ref.4**) repeatedly until Bluetooth mode is selected.

Go to the Bluetooth settings on your chosen device and ensure Bluetooth is switched on. Look for the available devices and "Majority Eddington" should then display to connect to.

Select the device to connect your Bluetooth device to the Majority Eddington. Once connected, the screen will display "Connected".

To choose the music you wish to play, you will need to choose the album or playlist from your device.

Please note: The radio only takes Bluetooth input from devices such as a phone or tablet.

System Settings: Sleep Timer

A sleep timer can be set to switch your radio to standby after the selected period of time.

To set a sleep timer, press the 'Menu' button (**Ref.8**) to open settings, and use the '^' or 'v' buttons (**Ref.1/3**) to scroll to the "System Settings" option. Select this option with the 'OK' button (**Ref.3**).

Once System Settings are open, use the '^' or 'v' buttons (**Ref.1/3**) to scroll to the "Sleep" option. Select this option with the 'OK' button (**Ref.2**).

Press the '^' or 'v' buttons (**Ref.1/3**) to switch between sleep times available. There is an option between Off, 15, 30, 45, 60, 90, minutes.

Select the sleep timer length you wish to set by selecting with the 'OK' button (**Ref.2**).

Once the sleep timer has been selected, the timer amount and a sleep image will show on the bottom left of the radio screen when on DAB, FM and Bluetooth modes.

To turn Sleep off, simply navigate back to "Sleep" settings and switch the timer to "Off".

System Settings: Dual Alarm

To set an alarm, press the 'Menu' button (**Ref.8**) to open settings, and use the '^' or 'v' buttons (**Ref.1/3**) to scroll to the "System Settings" option. Select this option with the 'OK' button (**Ref.2**).

Once System Settings are open, scroll to the "Alarm" option. Select this option with the 'OK' button (**Ref.2**).

The option to set Alarm 1 or Alarm 2 will now display. Select the alarm that you wish to set and the following alarm setting options will display:

Alarm: Press the 'OK' button (**Ref.2**) down repeatedly to switch between turning the alarm on and off.

Frequency: Select option to choose the regularity of the alarm between Daily, Once, Weekends and Weekdays. Select the chosen frequency by selecting with the 'OK' button (**Ref.2**).

Wake Up Time: The hour digits of the alarm will now begin to flash. Change the alarm hour with the '^' or 'v' buttons (**Ref.1/3**). Once on the chosen alarm hour, press the 'OK' button (**Ref.2**) to confirm. Follow the same process for setting the alarm minutes.

Source: Select between the following alarm wake-up tones: Buzzer, Digital Radio and FM. If Digital Radio or FM are selected, a new alarm setting option will display and allow you to choose one of your preset stations, or the last station played on the mode as your alarm tone.

Duration: Select the duration of the alarm tone between the following options: 15, 30, 45, 60, 90 or 120 minutes.

Volume: Use the '^' and 'v' buttons (**Ref.1/3**) to adjust the alarm volume and confirm with the 'OK' button (**Ref.2**).

Alarm Functions

To Cancel Alarm 1 or Alarm 2

To cancel an alarm, press the 'Menu' button (**Ref.8**) to open settings, and scroll to the "System Settings" option. Select this option.

Once System Settings are open, scroll to the "Alarm" option. Select this option.

The option to select Alarm 1 or Alarm 2 will now display. Select the alarm that you wish to cancel to open Alarm Settings.

Scroll to the "Alarm" option and press the 'OK' button (**Ref.2**) down repeatedly to switch between turning the alarm on and off. Once 'Off' is selected, press the 'Menu' button (**Ref.8**) to go back to settings.

How to turn off your alarm when sounding

Turn off the alarm by pressing the 'Standby/Mode' button (**Ref.4**) when it is sounding.

The screen will then display "Alarm Off".

How to put your alarm on snooze

To put the alarm on snooze for 9 minutes, press down the 'OK' button (**Ref.2**). The snooze timer will then display at the bottom of the screen. If you would like to stop the snooze function, press down the 'Standby/Mode' button (**Ref.4**). The screen will then display "Alarm Off".

System Settings: Additional Functions

To open setting options, press the 'Menu' button (**Ref.8**) to open and use the '^' or 'v' buttons (**Ref.1/3**) to scroll to the "System Settings" option. Select this option with the 'OK' button (**Ref.2**). Once System Settings are open, use the '^' or 'v' buttons to scroll through the following options:

Time/Date

Once this is selected, the following options will display for setting:

Set Time/Date: The day date will now begin to flash. Change the day with the '^' and 'v' buttons (**Ref.1/3**). Once on the chosen digit, press down the 'OK' button (**Ref.2**) to confirm. Follow the same process for setting the month and year.

The time can now be set and the hour digits of the time will begin to flash. Change the hour with the '^' and 'v' buttons (**Ref.1/3**). Once on the chosen time hour is displaying, press down the 'OK' button (**Ref.2**) to confirm. Follow the same process for setting the time minutes.

Auto Update: An automatic set of the clock and date for particular modes can be selected. Choose between: from Any, from Digital Radio, from FM, or No Update.

Set 12/24 Hour: Decide between a 12 and 24 hour clock display.

Set Date Format: Decide between two date formats for the display: DD-MM-YYYY or MM-DD-YYYY.

Backlight

Timeout: Select the option to choose the backlight display timeout. The screen will darken after the period of time selected. The timeout options are the following: On, 10, 20, 30, 45, 60, 90, 120 and 180.

On Level: Select this option to choose the on level screen brightness. The brightness options are High, Medium or Low.

Dim Level: Select this option to choose the dim level screen brightness. The brightness options are High, Medium or Low.

Language

Select your chosen default language for the radio from the list with the 'OK' button (**Ref.2**). Language options include Danish, German, English, French, Italian, Dutch and Spanish.

Factory Reset

Select this option to perform a factory reset. This would be advisable if your radio has any functionality issues. Once asked to confirm reset, select "Yes" with the 'OK' button (**Ref.2**).

Software Update

Select this option to see if a software update is available. If there is one available, please select "Yes" or "No".

Software Version

Select this option to view the software version of the radio.

Internal Rechargeable Battery

Play Time

The Eddington has an internal rechargeable battery that has a playtime of 10.5 - 12 hours when it is fully charged. This will allow you to take the radio on the go and use it portably.

If you want to turn your radio off, save the battery life by putting it into standby mode (**Ref.4**) and then turn off at the 'ON/OFF' switch (**Ref.10**).

To charge the radio, plug your radio into the mains with the power adapter provided.

Charging

The unit will charge in standby and working mode if it is connected to the mains.

To confirm that the unit is on charge, the charging icon at the top right of the screen will indicate the unit is charging and the level of charge. The radio will take approximately 4 hours to fully charge.

| Observation | Potential Cause/Solution |
|---|---|
| No sound | The station is not tuned in properly. Please perform a rescan for available stations or manually scroll through available stations. |
| Cannot preset stations | Ensure that you are pressing and holding down the Preset buttons for 2-3 seconds to open Preset Store settings. Only press, do not hold down, to open Preset Recall. |
| FM: Static sound DAB: Burbling/ intermittent cut-out | Signal reception is low. Adjust the aerial or move the unit to a stronger signal location. Rescan. Rescan stations and/or a factory reset. |
| Desired station not found | Weak signal. Use the manual tune function and try to rescan in a different area. |
| Buttons are not working | Check that the buttons are not locked. Press and hold the 'Lock/Menu' button for 2 seconds and the screen should display "unlocked" if buttons were locked. |
| Display is blank | This may occur if the broadcaster changes the label of a service or removes a label while tuned. The radio will try to retune or perform a scan. |
| Time and Date not setting automatically | For the time and date to set automatically you need to turn on the system and switch to DAB radio and let this scan. The date and clock will update automatically. Alternatively, you can set these in radio settings. |

Specifications

Specifications

| | |
|-------------------|---|
| Power input: | USB to Micro USB 5v 1A |
| Mode: | DAB/DAB+ 174-240MHz FM(87.5MHz – 108MHz) Bluetooth |
| Output Connector: | Earphone jack |
| Portability | Bluetooth mode: 12 hours DAB mode: 11 hours FM mode: 10.5 hours |
| Dimensions: | 12 x 2.3 x 6.4 cm |
| Weight: | 169g |

Warranty

All products come with a standard 12 month warranty. All items must be registered on www.majority.co.uk for the warranty to be valid. Once on the web page, use the menu to find "Register your Product". You will also be given the chance to extend your warranty for an additional 24 months, free of charge.

1. Read these instructions.

- Keep these instructions. Instructions are also available for download at www.majority.co.uk
- Heed all Warnings
- Follow all instructions
- Do not clean the apparatus near or with water
- Do not block any ventilation openings. Install in accordance with the manufacturer's instructions
- Do not block any ventilation openings. Install in accordance with the manufacturer's instructions.
- Do not install near any heat sources such as radiators, heat registers, stoves, or other apparatus (including amplifiers) that produce heat.
- Protect the power from being walked on or pinched particularly at plugs, convenience receptacles, and the point where they exit from the apparatus.
- Only use attachments/accessories specified by the manufacturer.
- Unplug this apparatus during light storms or when unused for long periods of time.
- Refer all servicing to qualified service personnel. Servicing is required when the apparatus has been damaged in a way, such as power-supply cord or plug is damaged, liquid has been spilled or objects have fallen into the apparatus, the apparatus has been exposed to the rain or moisture, does not operate normally or has been dropped.
- No naked flame sources, such as lit candles, should be placed on the apparatus.
- Dispose of used electrical products and batteries safely according to your local authority and regulations.

ADDITIONAL WARNINGS

The apparatus shall not be exposed to dripping or splashing and no objects filled with liquid, such as vases, shall be placed on the apparatus.

Main plug is used to disconnect device and it should remain readily operable during intended use. In order to disconnect the apparatus from the main mains completely, the mains plug should be disconnected from the main socket outlet completely.

Battery shall not be exposed to excessive heat such as sunshine, fire or the like.

RECYCLING ELECTRICAL PRODUCTS

You should now recycle your waste electrical goods and in doing so help the environment.



This symbol means an electrical product should not be disposed of with normal household waste.

Please ensure it is taken to a suitable facility for disposal when finished with.

IMPORTANT: Please read all instructions carefully before use and keep for future reference.



Risk of electric shock.
Do not open



Read all instructions carefully before use and keep for future reference



When servicing, use only identical replacement parts



CAUTION

RISK OF ELECTRIC SHOCK
DO NOT OPEN



ATTENTION

RISQUE D'ELECTROCUTION
NE PAS OUVRIR



IMPORTANT: Please read all instructions carefully before use and keep for future reference

MAJORITY

E D D I N G T O N

PORTABLE DIGITAL RADIO

EDD-DAB-BLK



Deutsche Anweisungen

Instructions guide ist in deutscher Sprache auf unserer website verfügbar: www.majority.co.uk



Instructions en Allemand

Le manuel d'instructions est en langue allemande notre site web disponible: www.majority.co.uk



Instrucciones Alemanas

La guía de instrucciones está en idioma alemán. Nuestro sitio web disponible: www.majority.co.uk



Istruzioni Tedesche

La guida alle istruzioni è in lingua tedesca il nostro sito web disponibile: www.majority.co.uk