

# Fitzwilliam 3 Internet Radio

User Manual

MAJORITY

---

HOME AUDIO • CAMBRIDGE

What's In the Box?	3
Instructions Guide	
Controls & Functions	4
Remote Control Operation Range	7
Basic Operations	8
Product Set-up/Getting Started	10
System Settings	12
Internet Radio	18
Podcasts	21
Spotify Connect	22
Music Player Operation	23
DAB/DAB+ Radio Operation	25
FM Radio Operation	29
Bluetooth Operation	31
Auxiliary Input	32
NetRemote	32
Using Headphones	33
Sleep Setting	34
Setting Alarm	35
Cancelling Alarm	36
Product Specification	37
Support & Warranty	39
Safety Information	40

**3 year**  
Warranty

Register your product online for a FREE 3 year  
extended warranty at: [www.majority.co.uk](http://www.majority.co.uk)

## What's in the Box?

- |    |                        |    |                   |
|----|------------------------|----|-------------------|
| A. | Majority Fitzwilliam 3 | D. | 2 x AAA Batteries |
| B. | Instruction Manual     | E. | WLAN Antenna      |
| C. | Remote Control         | F. | Mains Power Cable |

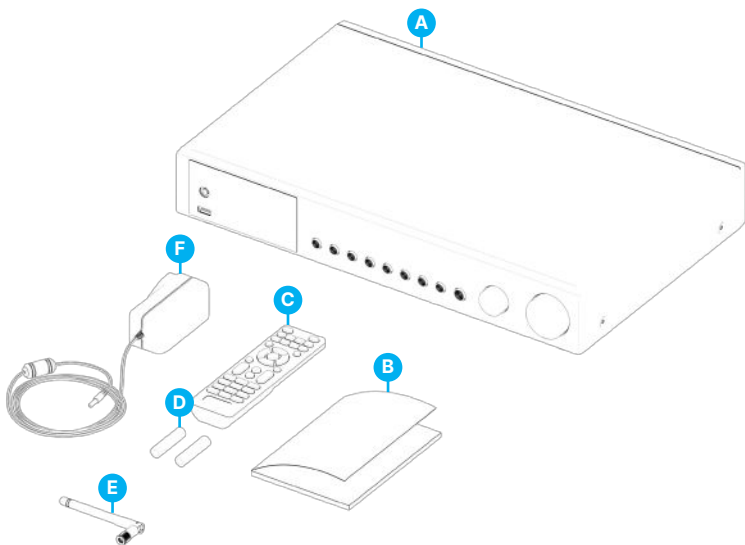

## Front View

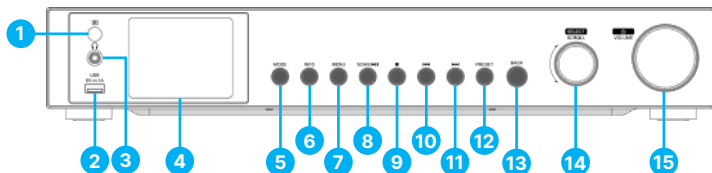

1. Remote Control Sensor
2. USB connection
3. Earphone Jack
4. Display
5. MODE Button
6. INFO Button
7. MENU Button
8. SCAN/PAUSE Button

9. ■ Button
10. ⏮ Button
11. ⏭ Button
12. PRESET Button
13. BACK Button
14. SELECT/SCROLL Dial
15. ON/VOLUME Dial

## Back View

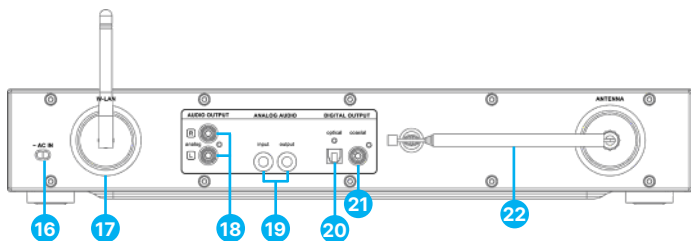

- |     |   |     |                          |
|-----|---|-----|--------------------------|
| 16. | Mains Connection Cable                  | 20. | Digital Output (Optical) |
| 17. | WLAN Antenna                            | 21. | Digital Output (Coaxial) |
| 18. | Audio Output L/R (Analogue, RCA jack)   | 22. | DAB/FM Antenna           |
| 19. | Analog Audio (input/output, 3.5mm jack) |     |                          |

## Remote Control Buttons

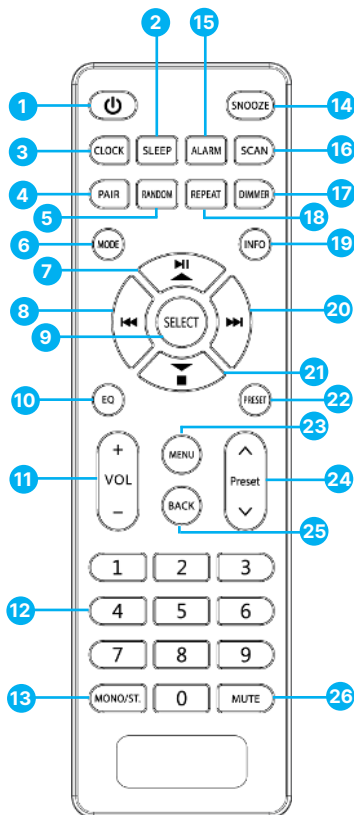

1. Power Button
2. SLEEP Button
3. CLOCK Button
4. PAIR Button
5. RANDOM Button
6. MODE Button
7. Play/Pause/UP Button
8. Previous Button
9. SELECT Button
10. EQ Button
11. VOL +/- Buttons
12. Number Buttons
13. MONO/ST. Button
14. SNOOZE Button
15. ALARM Button
16. SCAN Button
17. DIMMER Button
18. REPEAT Button
19. INFO Button
20. Next Button
21. Stop/Down arrow Button
22. PRESET Button
23. MENU Button
24. PRESET ^/ Buttons
25. BACK Button
26. MUTE Button

## Battery Replacement for the Remote Control

1. Press down the battery cover at '▼' and push the battery cover outwards in the direction of the arrow.
2. Insert 2 x AAA 1.5V batteries (not included). Make sure to match the (+) and (-) ends of the battery with the (+) and (-) ends indicated in the battery compartment.
3. Close the cover.

## Handling the Battery

Improper or incorrect use of batteries may cause corrosion or battery leakage which could cause fire, personal injury or damage to property.

Only use the battery type indicated in this manual.

Do not dispose of the used battery as domestic waste. Dispose of it in accordance with local regulations.

Remove the battery from the remote control when not in use for a long period of time, as corrosion or battery leakage may occur and result in physical injury, and/or property damage, and/or fire.

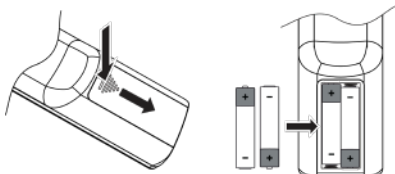

## Remote Control Operation Range

The remote-control sensor on the front unit is sensitive to the remote control's commands up to a maximum of 4 metres away and within a maximum of 60° arc.

*Note that the operating distance may vary depending on the brightness of the room.*

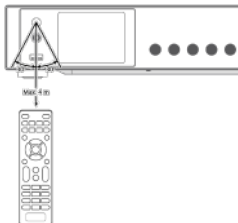

## Connection

1. The audio output (analogue), optical out (digital) and coaxial out (digital) are available on the back of the unit to connect the Majority Fitzwilliam 3 with an A/V amplifier, a HiFi system or external speakers.
2. Insert the DAB/FM antenna included in the product box into its port and extend to the desired length.
3. Connect the WLAN antenna included in the product box to the W-LAN socket at the back of the unit for WIFI connection.
4. Unwind the mains cable to its full length. Connect the power cable plug to the mains socket. The unit is now connected and ready to use.
5. To switch the unit off completely, unplug the power cable from the mains port.

 Be sure to connect the power cord to an AC outlet that supplies the correct voltage. Hold the power plug when plugging into an outlet or unplugging it. Never pull or yank on the power cord.

## Network Connection

This product only supports wireless connection for network access and does not support wired LAN connection.

### Wireless network

1. First of all, check whether the control lamps (LINK/ACT) of your router light up.
2. Proceed with the operations described in the below '**Getting Started.**' It is recommended to run through the setup wizard in the System Settings section.

 This unit cannot be connected to a stand alone modem directly. A router or a modem incorporated with a router must be used. Since there are various connection configurations, please follow the specifications and instructions of your telecommunication carrier, internet service provider, and router setting guidebook.



## Getting Started

This instruction manual explains the basic information for operating this unit. Unless otherwise stated, all operations described are based on remote control use.

## Powering ON/OFF

1. Press the **⏻ / Volume** dial on the unit or **⏻** button on remote control to switch the unit on.
2. Press the **⏻ / Volume** dial on the unit or **⏻** button on remote control to switch the unit to standby mode.

## Selecting Modes

Press **MODE** button on the unit or remote control to access Mode Menu. Turn the **SCROLL/SELECT** dial (on the unit or press **⏮ / ⏭** buttons on remote control to select. Press **SCROLL/SELECT** dial on the unit or **SELECT** button on remote control to switch between **Internet Radio, Podcasts, Spotify, Music Player, DAB Radio, FM Radio, Bluetooth Audio** and **AUX In** modes.

When the unit is idle for approximately 15 minutes, it will automatically switch to standby. To switch the unit off completely, unplug the power cable from the main socket. Please turn the unit off completely to save energy when not in use.

## Adjusting the Volume

- Turn the **⏻ button/VOLUME** dial on the unit or press the **VOL +/-** buttons on the remote control to adjust the volume.
- If you wish to turn the sound off, press the **MUTE** button on the remote control. Press the **MUTE** button again, turn the **⏻ / VOLUME** dial on the unit or press the **VOL +/-** buttons on the remote control to resume listening.

## Navigating the Menu

1. Press the **MENU** button on the unit or remote control to access the menu.
2. Turn the **SCROLL/SELECT** dial on the unit or press **▶ || ▲ ▼ ■** buttons on the remote to select your choice.
3. Press the **SCROLL/SELECT** dial on the unit or the **SELECT** button on the remote control to confirm your selection.

## Initial Set-Up

When you first connect the unit to the mains socket, the display will show the welcome screen, and then the language menu will show up. Turn the **SCROLL/SELECT** dial on the unit or press ► ◄ ▲ ▼ ■ buttons on the remote control to change the display language. Press the **SCROLL/SELECT** dial on the unit or the **SELECT** Button on the remote control to confirm.

The privacy policy page will come up. Please visit the website mentioned on the page to view the detailed privacy policy. Press the **SCROLL/ SELECT** dial on unit or **SELECT** button on the remote control to accept and move forward to the next step.

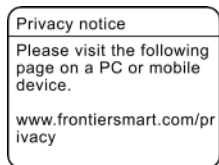

1. To launch the initial Setup Wizard, turn the **SCROLL/SELECT** dial on the unit or ◀ / ▶ buttons on the remote control to select [YES]. Press the **SCROLL/SELECT** dial on the unit or **SELECT** button on the remote control to confirm.
2. In the next screen, you can select the time format. Select the desired setting [12] or [24] and press the **SCROLL/SELECT** dial on the unit or **SELECT** button on the remote control to move on to the next step.
3. Here you can select which source (DAB/FM/Network/No update) the unit uses to obtain and update the time and date. If 'Update from Network' is selected, proceed to the next step to select the time zone, and ensure that the time is correctly displayed. Right after, select 'DAYLIGHT SAVINGS' as [ON] or [OFF].
4. In the next screen, you can specify whether the product should remain connected to the Internet when on standby. Turn the **SCROLL/SELECT** dial on the unit or press ◀ / ▶ buttons on the remote to Select [YES]. Press the **SCROLL/SELECT** dial on the unit or press the **SELECT** button on the remote to confirm.
5. Your radio will now scan for your wireless network - this may take a few seconds then a list of all the wireless networks will appear on the screen. Select the WLAN network you know and whether to use WPS (Wi-Fi Protected Setup) (Push Button/Pin) or Skip WPS to enter the password using the displayed keyboard.

## Connecting using the WPS button on your router

Connecting using the WPS (Wi-Fi Protected Setup) button on your router is a quick and easy way to connect your radio without having to type in a password. Select one of the following connection methods:

### Push button

If your router has a WPS button, you will notice [WPS] at the front of your network name.

6. Press ► II ▲ ▼ ■ buttons to select Push Button. Press the **SELECT** button to confirm.
7. You will now see a message on the screen telling you to press the WPS button on your router. Press the WPS button on your router. Check your routers instruction manual if you are unsure which button is the WPS button.
8. Press the **SELECT** button to confirm. Your radio will now connect to your router, this may take a few seconds.

### Pin (code number)

The radio generates an 8-digit code number. Enter this code number into the wireless router or access device.

## Connecting using your wireless network password

If your router has no WPS button you will now be asked to enter your wireless network password, or you can select **SKIP WPS** which also takes you to the password screen.

9. Press ► II ▲ ▼ ■ ◀ ▶ buttons to select each letter/number of your password. Press the **SELECT** button to enter the selected letter/number.
10. When you have entered your password, Press ► II ▲ ▼ ■ ◀ ▶ buttons to select OK on the right of the screen.
11. Once your radio has been connected, press the **SELECT** button to exit the setup.

The Network Settings can be changed at any time in the Menu - System Settings - Network - Network Wizard

Press the **MENU** button on unit or remote control to display the menu. Turn **SCROLL/SELECT** dial on unit or press ► II ▲ ▼ ■ buttons on the remote control to select System Settings, and then press **SCROLL/SELECT** dial on unit or **SELECT** button on the remote to confirm.

## Equalisers

This system supports a variety of equalisers and sound effects.

- Press the **EQ** button to access Equaliser menu.

Alternatively

- While in System Settings Mode, press ► II ▲ ▼ ■ buttons to select **Equaliser** and then press the **SELECT** button to confirm.
- The display will show: **NORMAL > CLASSIC > ROCK > POP > JAZZ > MY EQ > MY EQ PROFILE SETUP**
  - Press ► II ▲ ▼ ■ buttons to select your equaliser mode and then press the **SELECT** button to confirm.
  - For **[MY EQ]**, please go to **[My EQ Profile Setup]** for custom setting before selecting this option.
  - While in **[My EQ Profile Setup]**, press ► II ▲ ▼ ■ to select **[Bass/Treble]**, then press **SELECT** button to enter. Press ► II ▲ ▼ ■ to select desired levels for Treble and then press the **SELECT** button to confirm.
  - Press the **BACK** button to exit and then press ◀ / ▶ buttons to select **[YES]**. Press **SELECT** button to confirm. The Display will show **Equaliser Saved profile**.

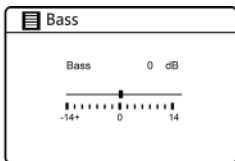
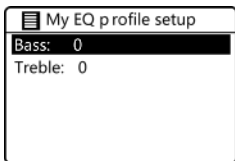

## Network

1. While in System Settings Mode, press ► || ▲ ▼ ■ buttons to select **Network**. Press the **SELECT** button to confirm.
2. Press ► || ▲ ▼ ■ buttons to select from the following settings, then press the **SELECT** button to confirm.
3. Press the **BACK** button on the unit or remote control to cancel the setting and return to the previous menu.

<b>Network Wizard</b>	SSID – select the desired wireless network. Rescan – Scan for available networks. Manual config – Select wireless network with DHCP (Dynamic Host Configuration Protocol) enable/disable.
<b>PBC WLAN Setup</b>	Select WPS on the unit and press the WPS button on the modem device that you wish to connect with. Press <b>SCROLL/SELECT</b> dial on unit or <b>SELECT</b> button on remote control to continue.
<b>View Settings</b>	Display the settings on the unit.
<b>Manual Settings</b>	Select wireless network with DHCP enable/disable.
<b>NetRemote PIN Setup</b>	To define a PIN number to be entered before being able to connect to the unit remotely over a network.
<b>Network Profile</b>	View the connected network.
<b>Clear Network Settings</b>	To delete the connected network memory in Network profile.
<b>Keep network connected</b>	To define whether remains connected to its network in Standby mode and when not in Network radio mode.

## Time/Date

The Time/Date can be set to automatically update from Internet Network, DAB or FM Radio or No update. *Note: When choosing 'No update,' you can manually set the time and date on the Fitzwilliam 3.*

Press the **CLOCK** button on remote control to access **Set Time/Date** menu to adjust Time/Date. Alternatively,

- While in System Settings Mode, press ► || ▲ ▼ ■ buttons to select **Time/Date**. Press the **SELECT** button to enter. Press ► || ▲ ▼ ■ buttons to select **Set Time/Date**. Press the **SELECT** button to confirm.
1. The date digits will flash on the display.
  2. Press ► || ▲ ▼ ■ buttons to adjust the date, then press the **SELECT** button to confirm.
  3. Repeat the above Step (2) to set the Month/Year/Hour/Minute.
  4. The date and time settings are now set.

For the other settings under Time/Date, press ► || ▲ ▼ ■ buttons to select from the following options and then press the **SELECT** button to confirm.

<b>Auto update</b>	DAB/FM/Network/No update
<b>Set format</b>	12 / 24 hour format
<b>Set Time zone</b>	Select a time zone. (Only available when Auto update from Network is on.)
<b>Daylight savings</b>	Select daylight savings. (Only available when Auto update from Network is on.)

The default auto-time update setting is 'Update from Network'. If you would like to manually set the time, it is recommended to turn the Auto update function off by selecting 'No update'.

## Inactive Standby

Use the Inactive Standby to turn off the unit after a specific time of use in play mode.

1. While in System Settings Mode, press ► || ▲ ▼ ■ buttons to select Inactive Standby. Press **SELECT** button to enter.
2. Press ► || ▲ ▼ ■ buttons to select between **Off**, **2 hours**, **4 hours**, **5 hours**, and **6 hours**. Press **SELECT** button to confirm.

## Language

1. While in System Settings Mode, press ► || ▲ ▼ ■ buttons to select **Language** and then press the **SELECT** button to enter.
2. Press ► || ▲ ▼ ■ buttons to change the display language as per your choice.
3. Press the **SELECT** button to confirm.

## Factory Reset

There may be times when you need to reset your unit back to the factory settings especially when for example you move house or when you experience reception problems, you may want to reset and try again. If you move to another part of the country and pick up the local and national DAB stations in that area, your previously tuned channels may no longer be available.

1. While in System Settings Mode, press ► II ▲ ▼ ■ buttons to select **Factory Reset**, and press the **SELECT** button to enter.
2. Press ◀◀ / ▶▶ buttons to select **[Yes]** and then press the **SELECT** button to confirm or select **[No]** to cancel.

When completing a factory reset, all settings, tuned stations, internet, DAB & FM preset stations will be erased.

## Software Update

1. While in System Settings Mode, press ► II ▲ ▼ ■ buttons to select **Software update** and then press the **SELECT** button to enter.
2. Press ► II ▲ ▼ ■ buttons to select 'Auto-check setting' or 'Check Now', then press the **SELECT** button to confirm.

**⚠** Before downloading software, ensure that the radio is plugged into a stable mains power connection. Interrupting power supply during software download/update can lead to functional disturbances and/or damage to the unit.

## Setup Wizard

The Setup Wizard is available in System Settings. You can run through this to configure Date/ Time or Network Settings. Once completed, your radio is ready for use.

## Info

1. While in System Settings Mode, press ► II ▲ ▼ ■ buttons to select **Info**, and then press the **SELECT** button to enter.
2. Available info is: The software version, Spotify version, Radio ID and Friendly name will show on the display.



## Privacy Policy

1. To view the Privacy Policy page, press **MENU** and go to **System Settings - Privacy Policy**.
2. After 'Factory reset', you need read and once more, agree with the **privacy policy**.

## Backlight

1. While in System Settings Mode, press ► **II** ▲ ▼ ■ buttons to select **Backlight**, and then press the **SELECT** button to enter.
2. To view **Backlight** settings, press ► **II** ▲ ▼ ■ buttons and select any of the following options. Press the **SELECT** button to confirm.

<b>Operation Mode Backlight</b>	High / Medium / Low
<b>Standby Mode Backlight</b>	Timeout: Off/ 10 sec/ 30 sec/ 60 sec Standby Level: High/ Medium/ Low/ Off

Alternatively, press the **DIMMER** button on the remote control repeatedly to adjust the Backlight level under ON mode or in Standby Mode.

If 'Timeout' is set as OFF, the display brightness in standby will be the same as in the operation mode, and you will not be able to use the **DIMMER** button on the remote control.

## Internet Radio

To listen to an Internet radio station your radio must be connected to the network. Try to position your radio as close as possible to your router to get the best connection speed. When Internet Radio Mode is selected, the radio connects with the Frontier Silicon Internet Radio portal to download a list of stations. Once a station is selected, the radio will connect directly to that station.



Press the **MODE** button on unit or remote control to access Mode Menu. Turn the **SCROLL/SELECT** dial on the unit or press **◀ / ▶** buttons on remote control to select Internet Radio Mode. Press the **SCROLL/SELECT** dial, then press on unit or the **SELECT** button on the remote control to confirm.

While in Internet Radio mode, press the **MENU** button on the unit or remote control to access the menu. You can choose between: **Last Listening**, **Station List**, **System Settings** and **Main Menu**. Press **▶ || ▲ ▼ ■** buttons to select and press the **SELECT** button to enter each section.

When the Internet Radio is restarted, the last listened to stations are automatically selected. To return to [Station List], press the **BACK** button.

## Last listened

1. Press **▶ || ▲ ▼ ■** buttons to select the history of stations that you played before.
2. Press the **SELECT** button to confirm.

## Station List

If it is the first time listening to Internet Radio, the radio will be in **[Station List]**.

Press ► || ▲ ▼ ■ buttons to select from the following options, and then press the **SELECT** button to confirm.

'Countries'	To search for specific stations from your country. Within this scope, it will display local radio stations.
'Search'	To search for stations using various keywords. The name and a description of your selected one will be displayed on the screen.
'Location'	To select radio stations from a list of countries available.
'Popular'	Select station from a list of the most popular internet stations from around the world.
'Discover'	Select stations from various categories: Country, Genre, or Language.

Press the **BACK** button on the unit or remote control to return to the menu.

## Preset Stations

The preset Internet Radio stations are stored on the Fitzwilliam 3 and cannot be accessed from other radio stations.

- To store an Internet Radio preset, you must first be listening to the station that you would like to save. Hold the **PRESET** button on the unit or remote control for 2 seconds until the display shows the option 'Save to Preset'.
- Using the ► || ▲ ▼ ■ buttons scroll through the list of the 30 preset slots, select the number, then press the **SELECT** button to confirm.

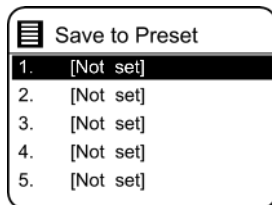

## Recalling a Stored Station

1. To recall a preset, press the **PRESET** button (do not press and hold) on the unit or remote control, then press the ► || ▲ ▼ ■ buttons to select one of the listed preset stations.
2. Press the **SELECT** button to confirm the selection.

Alternatively, on remote control,

- Press **Preset** up, down buttons to navigate through the preset stations.
- Or press the number keys (**1-9**) on remote control to quickly access the preset station 1-9, directly.
- If there is no station saved on a specific button, it will show **Preset empty**.

Operation of saving Presets and Recall stations are same for Internet Radio/podcasts, DAB and FM.

## Internet Radio Display Information

Press the **INFO** button repeatedly on the unit or remote control, to view various information on screen such as: **Channel Info/Description- Language/Location - Bit rate/Sound format/Sampling rate - Playback buffer - Date**.

## Podcasts

To listen to Podcasts, your radio must be connected to the Internet network. Try to position your radio as close as possible to your router to get the best connection speeds.

Press **MODE** button on unit or remote control to access Mode Menu.

Turn the **SCROLL/SELECT** dial on unit or press **◀ / ▶** buttons on remote control to select Podcasts mode. Press **SCROLL/SELECT** dial on unit or the **SELECT** button on the remote control to confirm.

## Last listened

1. Press **▶ || ▲ ▼ ■** buttons to select [Last listened], then press **SELECT** button to confirm.
2. Press **▶ || ▲ ▼ ■** buttons to select the history of stations that you listened to before, then press **SELECT** button to confirm your selection.

## Podcast List

While in Podcasts Mode, press the **MENU** button to access the menu. Press the **▶ || ▲ ▼ ■** buttons to select [**Podcast list**] and press the **SELECT** button to confirm.

When the radio is restarted, the last listened podcast is automatically selected. To return to [Podcast list], press the **BACK** button.

If it is the first time listening to Podcasts radio, the radio will be in [Podcast list].

Press the **▶ || ▲ ▼ ■** buttons to select from the following options, then press the **SELECT** button to enter each of the following.

'Countries'	To search for specific podcasts in your country. Within this scope, it will display local podcasts.
'Search'	To search podcasts using various keywords. The name and a description of your selected one will be displayed on the screen.
'Location'	To select podcasts from a list of countries available.
'Discover'	Select podcasts from various categories: Country, Genre, or Language.



## Spotify Connect

- Use your phone, tablet, or computer as a remote control for your Spotify Connect.
- Go to [spotify.com/connect](https://spotify.com/connect) to learn how.  Spotify

## Licenses

The Spotify Software is subject to third party licenses found here:  
<https://www.spotify.com/connect/third-party-licenses>

## Music Player Operation

The built-in Music Player allows you to play unprotected audio files stored on a connected USB stick to Fitzwilliam 3's USB port.

Press the **MODE** button on unit or remote control to access Mode Menu. Turn the **SCROLL/SELECT** dial on unit or press **◀ / ▶** buttons on remote control to select Music Player Mode, then press **SCROLL/SELECT** dial on unit or **SELECT** button on remote control to enter.

## USB Playback Mode

- When a USB stick is connected to the unit under Music Player Mode, the display shows 'USB disk attached – Open folder?' press **SELECT** button to confirm [YES].

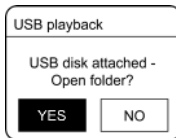

**⚠** Alternatively,

- While in Music Player Mode, press the **▶ || ▲ ▼ ■** buttons to select **USB Playback** and press the **SELECT** button to confirm.

Press the **▶ || ▲ ▼ ■** buttons to select and press the **SELECT** button to start playing.

- The Majority Fitzwilliam 3's supports MP3 audio file format for USB playback.
- The unit can support USB stick of up to 128GB.
- The unit may not be compatible with all USB sticks therefore this is not an indication of a problem with the unit

## Playing Music via Music Player

- Press the '**SCAN / ▶ ||**' button on the unit or **▶ || / ▲** button on the remote control to play/pause music or
- Press **◀ / ▶** buttons on the unit or remote control to skip to the previous/next track.

## My Playlist

1. While in Music Player menu, press ► || ▲ ▼ ■ buttons to select '**My Playlist**' and press the **SELECT** button to enter.
2. Press ► || ▲ ▼ ■ buttons to select songs and press the **SELECT** button to start playing from the playlist.

## Saving songs into My Playlist

- To store a song into 'My Playlist' while playing a song press and hold for 2 seconds the **SELECT** button to save.

## Repeat

1. While in Music Player menu, press the ► || ▲ ▼ ■ buttons to select **Repeat Play** and press the **SELECT** button repeatedly to turn 'Repeat play' on/off. A corresponding 'Repeat' symbol appears in the status bar.
2. Alternatively, press the **REPEAT** button on remote control repeatedly to turn mode on/off.

## Shuffle

1. While in Music Player menu, press the ► || ▲ ▼ ■ buttons to select **Shuffle Play**, and then press **SELECT** button repeatedly to turn the 'Shuffle play' on/off. A corresponding 'Shuffle' symbol appears in the status bar.
2. Alternatively, press the **RANDOM** button on remote control repeatedly to turn shuffle on or off.

## Charge a device using the USB port.

You can charge your device using the USB port on Majority Fitzwilliam 3, using a USB cable (not supplied).

1. The maximum current for USB charging is 1A.
2. Not all devices are guaranteed to be charged via Fitzwilliam 3 USB port.
3. USB charging function is not supported under Music Player mode.



## DAB Operation

Press the **MODE** button on unit or remote control to access Mode Menu. Rotate the **SCROLL/SELECT** dial on unit or press **◀ / ▶** buttons on the remote control to select **DAB Radio** mode. Press **SCROLL/SELECT** dial on unit or **SELECT** button on remote control to confirm. Fitzwilliam 3 will enter DAB mode and perform an automatic scan. During the scan, the display will read '**Scanning...**' together with a slide bar that indicates the progress and the number of stations found. Once the scan has been completed, the unit will select the first alphanumerically found station.

To explore the list of the DAB radio stations found, press **▶ || ▲ ▼ ■** buttons to select, and then press the **SELECT** button to confirm.

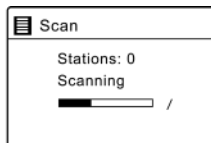
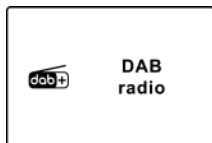

## Station List

1. While in DAB Mode, press the **MENU** button to access **DAB** menu.
2. Press **▶ || ▲ ▼ ■** buttons to select **Station List**, then press the **SELECT** button to enter.
3. A list of DAB stations found will be displayed on the screen.

## Auto Scan

Press the '**SCAN / ▶ ||**' button on unit or the **SCAN** button on remote control to activate auto scan. Alternatively,

Press the **MENU** button, then press **▶ || ▲ ▼ ■** buttons to find and select **Scan**. Press the **SELECT** button to confirm.

1. The display will then read '**Scanning...**' and a progress slide bar.
2. All DAB radio stations found will be automatically stored. To explore and listen to the found stations, press **▶ || ▲ ▼ ■** buttons to select, then press the **SELECT** button to confirm.

## Manual Tuning

As well as the auto tune function, you can manually tune the receiver. This feature can help you when you would like to align your aerial or add new radio stations that you might have missed when scanning automatically.

1. Press the **MENU** button to display the menu.
2. Press **▶ || ▲ ▼ ■** buttons to select **Manual Tune**, and then press the **SELECT** button to confirm.
3. The display will show the multiplex 5A to 13F.
4. Press **▶ || ▲ ▼ ■** buttons to select the channel, and then press the **SELECT** button to confirm.
5. To listen to any stations found, return to the now playing screen and press **▶ || ▲ ▼ ■** buttons to select the required station from the station list and press **SELECT** button to confirm.

## DAB Display Information

Press the **INFO** button on the unit or the remote control repeatedly to scroll through the info available. The display will show various info in each button press such as: DLS (Dynamic Label Segment) – Programme Type – Ensemble/Frequency – Signal error/Strength – Bit rate/Codec/Channels – Date

### DLS (Dynamic Label Segment)

This is a scrolling message giving real-time information, e.g., song titles, news headlines, etc.

### Programme Type

Describes the style or genre of the programme that is being broadcast.

### Ensemble Name/Frequency

Displays the name of the multiplex that contains the station you are listening to and the frequency. A multiplex is a collection of radio stations that are bundled and transmitted on one frequency. There are national and local multiplexes. Local ones contain stations that are specific to that area.

## Signal Error/ Signal Strength

The signal error is indicated with a number. If the number is 0, it means the signal received is error free and the signal strength is strong. If the error rate is high, it is recommended to reposition the radio aerial or reposition the unit. The display will show a slide bar to indicate the signal strength, the stronger the signal, the longer the bar will be from left to right.

## Bit Rate / Codec / Channels

The display will show the digital audio bit rate being received with additional information about the audio codec and channel configuration.

## Date

Displays the current date provided automatically by the broadcaster.

## Prune Invalid

You may remove all unavailable stations from the list.

1. While in DAB Mode, press the **MENU** button and press ► || ▲ ▼ ■ buttons to select **Prune invalid**. Press the **SELECT** button to confirm.
2. Press ◀▶ / ▶▶ buttons to select **[YES]**, then press the **SELECT** button to confirm. Or select **[NO]** to cancel.

## DRC (Dynamic Range Compression)

If you are listening to music with high dynamic range in a noisy environment, you may wish to compress the audio dynamic range.

1. While in DAB Mode, press the **MENU** button, then press ► || ▲ ▼ ■ buttons to select **DRC** and press the **SELECT** button to confirm.
2. Press ► || ▲ ▼ ■ buttons to select DRC high/low/off then press the **SELECT** button to confirm the setting.

## Station Order

You may wish to arrange the station listing order.

1. While in DAB Mode, press the **MENU** button and press ► || ▲ ▼ ■ buttons to select **Station order** and press the **SELECT** button to enter.
2. Press ► || ▲ ▼ ■ buttons to select **Alphanumeric/Ensemble** then press the **SELECT** button to confirm the setting.

## Saving and Recalling Preset Station

- Refer to 'Preset Stations' and 'Recalling a Stored Station' under Internet Radio section for instruction (p.18).

## FM Operation

Press the **MODE** button on unit or remote control to access Mode Menu.

Rotate the **SCROLL/SELECT** dial on unit or press **◀▶** buttons on the remote control to select FM Radio mode. Press **SCROLL/SELECT** dial on the unit or the **SELECT** button on the remote control to confirm.

The display will show the frequency.

## Auto Scan

- Press the '**SCAN/▶**' button on unit or '**SCAN/▶ II**' button on remote control to start searching for a station. Once a station has been found, the scanning will stop automatically.

Alternatively,

- Press and hold for 2 seconds **▶ II ▲ ▼ ■** buttons to start searching for a station.

The automatic scan search may not stop at a station with a very weak signal.

## Manual Tuning

To search for FM stations manually, turn the **SCROLL/SELECT** dial on unit or press **▶ II ▲ ▼ ■** buttons on remote control repeatedly until your desired frequency is reached.

**▲** With FM Radio, it may be necessary to fine tune each station by rotating the **SCROLL/SELECT** dial on unit or pressing **▶ II ▲ ▼ ■** buttons on the remote control repeatedly. Each press will adjust the frequency by 0.05 MHz. If the signal reception is still poor, adjust the position of the aerial or try moving the radio to another location.

## FM Display Information

Press repeatedly the **INFO** button on the unit or remote control to scroll through the info available. The display will show various info in each button press such as: **Radio Text – Programme Type – Frequency – Date**.

### RDS (Radio Data System) Radio Text

The display shows a scrolling message with information of current playing programme.

### Programme Type

Describes the style and genre of music that is being broadcast.

## Station Name / Frequency

When an RDS station is received, the name of that station will be displayed. If this info is not available, then the frequency will be displayed.

## Date

Displays the current date provided automatically by the broadcaster.

## Scan Setting

1. Press the **MENU** button to access **FM** Mode menu.
2. Press **▶ II ▲ ▼ ■** buttons to select **Scan Setting**, then press the **SELECT** button to enter.
3. Press **⏮ / ⏭** buttons to select **[Yes]** to receive strong signal only, then press the **SELECT** button to confirm.

## Audio Setting

1. Press the **MENU** button to access the FM Menu.
2. Press **▶ II ▲ ▼ ■** buttons to select **Audio Setting** then press the **SELECT** button to enter.
3. Press **⏮ / ⏭** buttons to select **[Yes]** to listen in mono only or **[NO]** to let the unit automatically select Stereo or Mono.
4. Press the **SELECT** button to confirm.

Alternatively, press the **MONO/ST.** button on the remote control to toggle between the **Mono only** or **Mono/Stereo** selection.

## Saving and Recalling Preset Station

- Refer to 'Preset Stations' and 'Recalling a Stored Station' under Internet Radio section for instruction at (p.18).

## Bluetooth Operation

The unit has a Bluetooth function that can receive a signal within 8 metres. Pair the unit with a Bluetooth device such as a phone or a tablet to play music from:

1. Press the **MODE** button on Fitzwilliam 3 or the one on remote control to access the Mode Menu. Turn the **SCROLL/SELECT** dial on unit or press **◀ / ▶** buttons on remote control to select **Bluetooth Audio** mode, then press the **SCROLL/SELECT** dial on unit or **SELECT** button on remote control to confirm.
2. If the unit is not paired with any Bluetooth device, the Bluetooth logo will start to flash indicating that the unit is now in pairing mode.
3. Activate your Bluetooth device and search for it. The **'Majority Fitzwilliam 3'** will appear on your Bluetooth devices list.
4. Select **'Majority Fitzwilliam 3'** and enter '0000' for the password, if required. Once connected, the Bluetooth logo on the screen will stop flashing indicating that both devices are now paired.
5. To stop the existing Bluetooth connection and pair with another device, press and hold for 2 seconds the **Stop** button on unit or press **PAIR** button on remote control to pair with another device.
6. To disconnect the Bluetooth function, switch the Majority Fitzwilliam 3 into a different mode or disconnect and remove the Majority Fitzwilliam 3 from the device that it has been paired with.

## Playing Music via Bluetooth

Press the **'SCAN / ▶ II'** button on unit or **'▶ II ▲'** button on the remote control to play/pause music. Press **◀ / ▶** buttons on the unit or on the remote control to skip to the previous/next track.



- The operational range between the unit and the device is approximately 8 metres.
- If the signal strength is weak, your Bluetooth receiver may disconnect, but it will re-enter pairing mode automatically.
- For better reception, remove any obstacles between the unit and the Bluetooth device.
- Compatibility with all devices and media types is not guaranteed.
- Some mobile phones with the Bluetooth function may connect and disconnect as you make and end calls. This is not an indication of a problem with your unit.

Control and adjust the volume on Fitzwilliam 3 and on your Bluetooth device.

## Auxiliary Input

The AUX-INPUT can be used to play sound from an external device such as a phone, tablet, or similar device.

1. Connect the external device to the Analogue Audio Input on the Fitzwilliam 3 using a 3.5 mm AUX cable (not included).
2. Press the **MODE** button on unit or remote control to access Mode Menu. Rotate the **SCROLL/SELECT** dial on unit or press buttons **◀ / ▶** on remote control to select **AUX In** mode. Press **SCROLL/SELECT** dial on unit or **SELECT** button on remote control to confirm.
3. Press the **VOL +/-** buttons on the remote control to adjust the volume control at your desired sound output level. Set the desired volume on the radio and on the external audio device if necessary.
4. In AUX Playback Mode, control the audio features via your external device.

 When connecting the external audio device, refer to the owner's manual.

## NetRemote

Majority Fitzwilliam 3 can be controlled using the NetRemote installed on a smartphone or tablet in iOS or Android system only. By downloading the **UNDOK app**, you can view all the modes of **Internet Radio**, **Podcasts**, **Spotify**, **Music Player**, **DAB**, **FM**, **Bluetooth** and **AUX In** on your device.

Search for **UNDOK** on Google Play (Android) or Apple Store(iPhone) and install the app on your smartphone or tablet.

Before using the **UNDOK** app, make sure the Fitzwilliam 3 and the smartphone or tablet are in the same Wi-Fi network. Launch the app.

The app initialises and scans for the devices available within the network. Find and select The Majority Fitzwilliam 3 from the list to connect.

- Once the smartphone or tablet accessed via UNDOK app the Fitzwilliam 3, will automatically connect the next time when you open the app again.
- Be aware that if another smartphone or tablet with the same app are connected within the same network the original connection will be cut off.

When you connect for the first time with the unit, you may be asked to enter a PIN code. The default PIN is **1234**. For details of changing the PIN for security, please refer to **System Settings** section: **Network - NetRemote PIN Setup**.

Select your desired mode on the main page of your device app. Control the selected mode on your smartphone or tablet and the device simultaneously.



## Using Headphones

Do not listen to music at high volume when using headphones. Doing so can cause permanent hearing impairment. Turn the tuner volume level to the lowest level before using headphones.

- Use wired headphones with a 3.5 mm jack plug (not included).
- Insert the headphone connector in the headphone socket which can be found on the Fitzwilliam 3 front panel.

 Long-term exposure to loud music can cause ear damage. It is best to avoid extreme volume when using earphones, especially for extended periods of time.

## Sleep Setting

This function allows you to program the unit to switch to Standby Mode by itself after a set period of time.

1. To activate the sleep function, press the **SLEEP** button on the remote control repeatedly. The time will change in the below sequence on each button press:



Sleep OFF → 15 minutes → 30 minutes → 45 minutes → 60 minutes → 90 minutes → 120 minutes

2. When your desired sleep time appears in the display, stop pressing the button and the sleep timer will be activated in two seconds. '☾##' will show on the display. Next to the sleep icon, you will also see the remaining time until the unit will switch off displayed on the screen.
3. When the sleep timer counts down to zero, the unit will switch to Standby Mode. To switch OFF the sleep function, while the sleep timer is still counting down, press the **SLEEP** button repeatedly to select 'SLEEP OFF'.

### Alternatively,

1. Press the **MENU** button on the remote control to access the main menu. Press ► II ▲ ▼ ■ buttons to select menu, and then press the **SELECT** button to enter.
2. Press ► II ▲ ▼ ■ buttons to select Sleep, and then press the **SELECT** button to enter.
3. Press ► II ▲ ▼ ■ buttons to select sleep timer length as OFF, and then press the **SELECT** button to confirm.

## Setting the Alarm

1. Press the **ALARM** button on the remote control, the display shows 'Alarm (1 or 2): Off [hh:mm]'.
2. Press ► || ▲ ▼ ■ buttons to select the Alarm number (1 or 2) then press the **SELECT** button to start to enter.

Press ► || ▲ ▼ ■ buttons to select one of the following options then press the **SELECT** button to confirm

'Enable'	Off/ Daily/ Once/ Weekends/ Weekdays
'Time'	(Alarm On time)
'Mode'	Buzzer/ Internet radio/ DAB/ FM
'Preset'	Last Listened/ (Preset station)
'Volume'	0-32
'Save'	Save and confirm the alarm setting

3. Finally, select 'SAVE', and then press the **SELECT** button to save the alarm setting. The display will show

**Alarm Saved.** When the alarm is set, the alarm icon will appear on the display.

4. To temporarily switch off the alarm, press the **SNOOZE** button on the remote control to activate the Snooze function when the alarm sounds. Press the **SNOOZE** button on the remote control repeatedly to set snooze period time to **5, 10, 15** or **30** minutes in turn. The set snooze time will show on the display and unit will go to standby.
5. To turn off the alarm when it sounds, press the **VOLUME** dial on the unit or Power button on remote control, or the **ALARM** button on remote control.

## Cancelling the Alarm

1. Press the **ALARM** button on the remote control, and the display will show 'Alarm (1 or 2): On [hh:mm]'.
2. Press the ► || ▲ ▼ ■ buttons to select the Alarm number (1 or 2), and then press **SELECT** button to start the setting of the timer.
3. Press the ► || ▲ ▼ ■ buttons to select 'Enable' and then press the **SELECT** button to confirm.
4. Press the ► || ▲ ▼ ■ buttons to select 'Off' and then press the **SELECT** button to confirm.
5. Finally, select 'Save' and then press the **SELECT** button to save the setting.
6. Alternatively, during Standby Mode, press the **ALARM** button on the remote control repeatedly to turn the saved Alarm 1/2 on/off sequentially.

## Product Specifications

<b>Power Supply</b>	AC100-240V ~ 50/60Hz
<b>Power Consumption</b>	7.8W
<b>Working Environment - Temperature</b>	0 ~ 35 °C
<b>Net Weight</b>	Main unit: app. 2.3 kg
<b>Unit Dimension (W) × (D) × (H)</b>	435 x 298 x 74 mm
<b>Radio Frequency</b>	M 87.50 – 108.00 MHz DAB 174.928 – 239.200 MHz
<b>Power Supply</b>	DC 5V 1A
<b>Power Consumption</b>	1.66A Max
<b>Working Environment - Temperature</b>	750g
<b>Net Weight</b>	13.8cm x 13.8cm x 6.9cm (LxWxH)

### How to activate wireless network port:

- Connect the unit with power.
- Switch to wireless mode (e.g., Internet)

### How to deactivate wireless network port:

- Go to Main menu - System settings - Network - Keep network connected. Select No then press **SELECT** button to keep network disconnected.

<b>Bluetooth version</b>	<b>Version</b>	V4.2(only support BR+EDR)
	<b>Maximum transmitted power</b>	5 dBm
	<b>Frequency band</b>	2402 - 2480 MHz
<b>Wi-Fi</b>	<b>Maximum transmitted power</b>	15 dBm
	<b>Frequency band</b>	2412 - 2472 MHz

**Standby power consumption:**

Wi-Fi off: < 1.00 W (standard standby mode) Wi-Fi on: < 2.00 W (network standby mode)

**Note:**

- The equipment will enter network standby mode after approx. 15 minutes.
- It is inappropriate for the intended use of equipment if the apparatus did not receive radio signal on FM mode.
- In Internet Radio, Podcasts, Spotify, Music Player, DAB Radio, Bluetooth Audio, AUX In mode, the unit will automatically go to Standby Mode after 15 minutes if it has no audio playback. Press the Standby button to resume.
- The product may have noise (1KHz signal) in the presence of strong electromagnetic fields, in case of malfunction due to these strong electromagnetic fields, user need to wait till resume normal operation without intervene.'

## Support

Thank you for purchasing the Majority Fitzwilliam 3. Please follow the guidance of the manual to set up your device and enjoy its fantastic features. If you require further assistance with your new device, please contact our support team on the Majority website: <https://www.majority.co.uk/support>

## Warranty

Register your product within 30 days of purchase at [www.majority.co.uk](http://www.majority.co.uk) to activate your extended warranty. Terms and conditions apply.

1. Read these instructions.
2. Keep these instructions. Instructions are also available for download at [www.majority.co.uk](http://www.majority.co.uk).
3. Heed all warnings.
4. Follow all instructions.
5. Do not clean the apparatus near or with water.
6. Do not block any ventilation openings. Install in accordance with the manufacturer's instructions.
7. Do not block any ventilation openings. Install in accordance with the manufacturer's instructions.
8. Do not install near any heat sources such as radiators, heat registers, stoves, or other apparatus that produce heat.
9. Protect the power from being walked on or pinched particularly at plugs, convenience receptacles, and the point where they exit from the apparatus.
10. Only use accessories specified by the manufacturer.
11. Unplug this apparatus during light storms or when unused for long periods of time.
12. Refer all servicing to qualified service personnel.
13. No naked flame sources, such as a lit candle should be placed on the apparatus.
14. Dispose of used electrical products and batteries safely according to your local authority and regulations.

## ADDITIONAL WARNINGS

The apparatus shall not be exposed to dripping, splashing or objects filled with water.

The main plug is used to disconnect the device. In order to disconnect the apparatus from the main mains completely, the mains plug should be disconnected from the main socket outlet completely.

Battery shall not be exposed to excessive heat.

## RECYCLING ELECTRICAL PRODUCTS

You should now recycle your waste electrical goods and in doing so help the environment.



This symbol means an electrical product should not be disposed of with normal household waste. Please ensure it is taken to a suitable facility for disposal when finished.

**IMPORTANT: Please read all instructions carefully before use and keep for future reference.**



Risk of electric shock.  
Do not open.



Read all instructions carefully before use and keep for future reference.



When servicing, use only identical replacement parts.



### ATTENTION

RISK OF ELECTRIC SHOCK DO NOT OPEN



### CAUTION

RISQUE D'ELECTROCUTION NE PAS OUVRIR



**IMPORTANT:** Please read all instructions carefully before use and keep for future reference



# MAJORITY

[www.majority.co.uk](http://www.majority.co.uk)

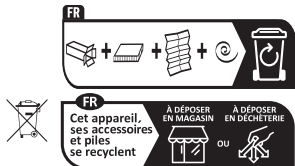

Points de collecte sur [www.quefairedemesdechets.fr](http://www.quefairedemesdechets.fr)  
Privilégiez la réparation ou le don de votre appareil !